

DESIGNED: SAT
DRAWN: DLR
REVIEWED: DLR
THESE PLANS AND DESIGNS ARE COPYRIGHT PROTECTED AND MAY NOT BE USED IN WHOLE OR IN PART WITHOUT THE WRITTEN CONSENT OF PINNACLE ENGINEERING GROUP, LLC

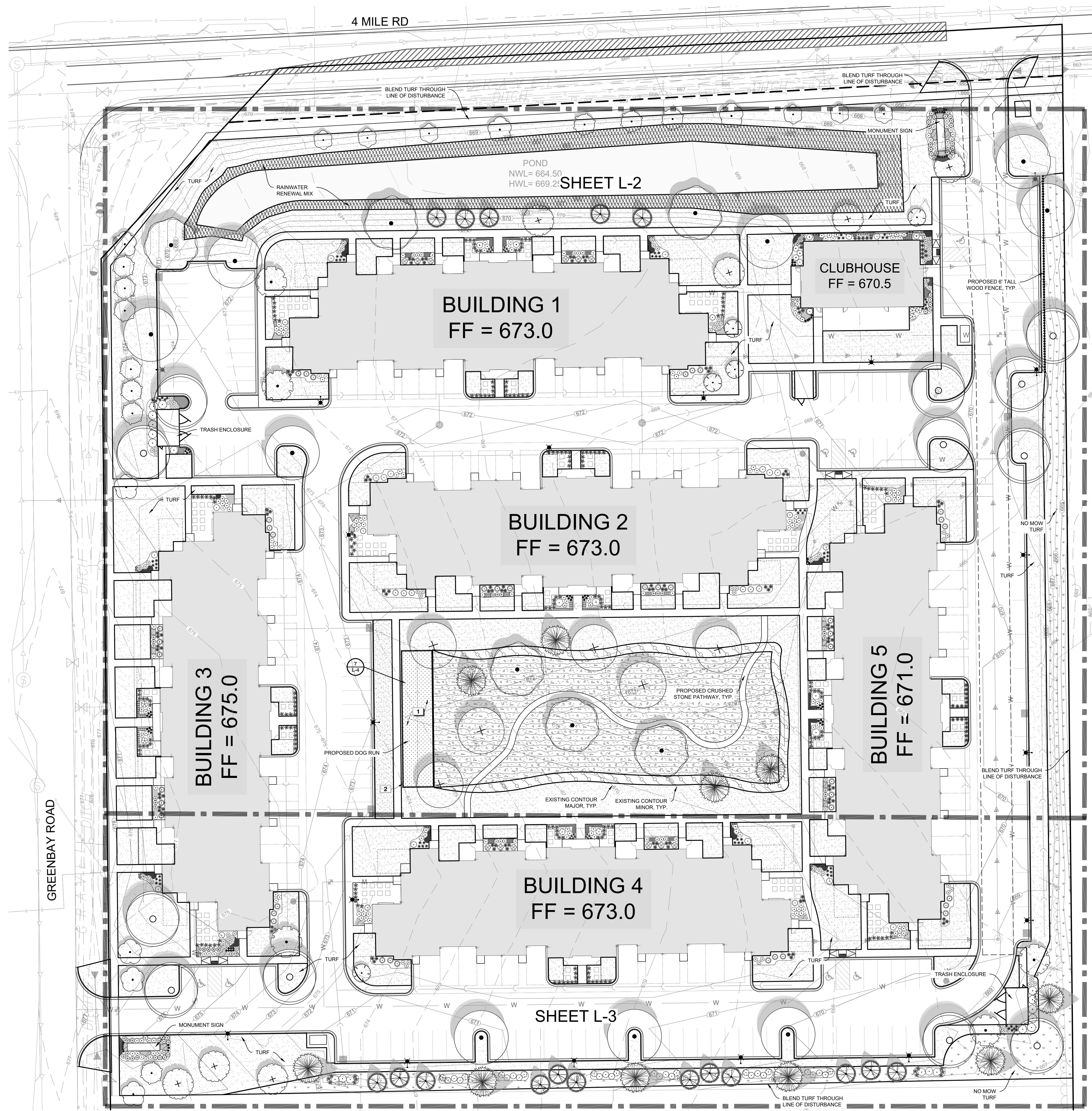

PLANT SCHEDULE

SYMBOL	QTY	BOTANICAL NAME	COMMON NAME	SIZE	REMARKS
TREES					
	7	Acer platanoides 'Columnare'	Columnar Norway Maple	2" Cal.	45 T x 15 W
	9	Acer platanoides 'Emerald Queen'	Emerald Queen Maple	2" Cal.	45 T x 40 W
	6	Celtis occidentalis 'Chicagoland'	Chicagoland Hackberry	2" Cal.	50 T x 40 W
	6	Celtis occidentalis 'Prairie Sentinel'	Prairie Sentinel Hackberry	2" Cal.	45 T x 12 W
	10	Ginkgo biloba 'Fastigiata'	Fastigiata Maidenhair Tree	2" Cal.	40 T x 15 W
	7	Liriodendron tulipifera 'Emerald City'	Emerald City Tulip Tree	2" Cal.	55 T x 25 W
	6	Platanus x acerifolia 'Morton Circle'	Exclamation London Plane Tree	2" Cal.	60 T x 45 W
	12	Ulmus x 'Morton Glossy'	Triumph Elm	2" Cal.	55 T x 40 W
EVERGREEN TREES					
	17	Picea glauca 'Densata'	Black Hills Spruce	6' Ht.	30' T x 15' W
	10	Pseudotsuga menziesii	Douglas Fir	5' Ht.	60' T x 25' W
ORNAMENTAL TREES					
	5	Carpinus caroliniana 'JN Strain'	Fire King Musclegwood	1.5' Cal.	20 T x 20 W
	5	Syringa reticulata 'Summer Storm'	Summer Storm Tree Lilac	1.5' Cal.	17 T x 12 W

SYMBOL	CODE	QTY	BOTANICAL NAME	COMMON NAME	SIZE	REMARKS
SHRUBS						
	75	Cornus sanguinea 'Anny's Winter Orange'	Anny's Winter Orange Dogwood	24" Ht.	4 T x 4 W	
	14	Cornus sericea 'Bergeson's Compact'	Bergeson's Red Twig Dogwood	24" Ht.	5 T x 5 W	
	7	Cotinus coggygria 'Lilia'	Lilia Dwarf Smoke Tree	24" Ht.	4 T x 4 W	
	12	Diervilla x 'G2X8854'	Kodiak Orange Diervilla	2 gal.	4 T x 4 W	
	58	Hydrangea paniculata 'SMHPS'	Razzleberry™ Hydrangea	18" Ht.	3 T x 3 W	
	5	Philadelphus coronarius 'Aureus'	Golden Mockorange	24" Ht.	6 T x 5 W	
	11	Syringa meyeri 'Palibin'	Dwarf Korean Lilac	24" Ht.	5 T x 5 W	
	78	Syringa x 'SMNRRP'	Blooming Dwarf Pink Lilac	24" Ht.	4 T x 5 W	
	25	Weigela florida 'Bokraspiwi'	Spilled Wine Weigela	18" Ht.	3 T x 3 W	
EVERGREEN SHRUBS						
	12	Juniperus chinensis 'Mint Julep'	Mint Julep Juniper	24" Ht.	5 T x 7 W	
	8	Juniperus chinensis 'Blue Vase'	Blue Vase Juniper	24" Ht.	4 T x 4 W	
	40	Juniperus horizontalis 'Blue Forest'	Blue Forest Creeping Juniper	24" W	11 T x 4 W	
	12	Pinus mugo pumilio	Dwarf Mugo Pine	24" Ht.	4 T x 5 W	
	42	Pinus strobus 'Blue Shag'	Blue Shag White Pine	24" Ht.	5 T x 5 W	
	12	Taxus x media 'Herbs Low Dense'	Herbs Low Dense Yew	24" Ht.	4 T x 5 W	
	12	Taxus x media 'SMTHDB'	Stonehenge Dark Druid® Yew	18" Ht.	3 T x 3 W	
	35	Thuja occidentalis 'Hetz Midget'	Hetz Midget Arborvitae	18" W	3 T x 3 W	
	40	Thuja occidentalis 'Art Boe'	North Pole® Arborvitae	4' Ht.	10 T x 4 W	
ORNAMENTAL GRASSES						
	135	Andropogon gerardii 'Blackhawks'	Blackhawks Big Bluestem	1 gal.	48 T x 30 W	
	24	Deschampsia cespitosa 'Pixie Fountain'	Pixie Fountain Tufted Hair Grass	1 gal.	15 T x 18 W	
	26	Hakonechloa macra 'Nicolas'	Nicolas Japanese Forest Grass	1 gal.	20 T x 20 W	
	68	Miscanthus sinensis 'Little Kitten'	Little Kitten Eulalia Grass	1 gal.	24 T x 15 W	
	210	Panicum virgatum 'Prairie Sky'	Prairie Sky Switch Grass	1 gal.	4 T x 3 W	
	5	Pennisetum alopecuroides 'Little Bunny'	Little Bunny Fountain Grass	1 gal.	18 T x 18 W	
	70	Schizachyrium scoparium 'Standing Ovator'	Standing Ovator Little Bluestem	1 gal.	4 T x 2 W	
PERENNIALS						
	DW 17	Dianthus gratianopolitanus 'Firewitch'	Firewitch Cheddar Pink	4.5" Cont.	12" o.c.	6 T x 12 W
	EL2 62	Echinacea x 'Balsomemym' TM	Sombreno Lemon Yellow Improved Coneflower	4.5" Cont.	24" o.c.	28 T x 28 W
	GAP 159	Gaillardia aristata 'Arizona Sun'	Arizona Sun Blanket Flower	4.5" Cont.	14" o.c.	12 T x 14 W
	HG 24	Heuchera x 'Georgia Peach'	Georgia Peach Coral Bells	4.5" Cont.	18" o.c.	15 T x 20 W
	HH3 4	Hosta sieboldiana 'Northern Exposure'	Northern Exposure Hosta	1 gal.	40" o.c.	36 T x 50 W
	HR8 100	Hosta x 'Rainforest Sunrise'	Rainforest Sunrise Hosta	4.5" Cont.	15" o.c.	12 T x 18 W
	NX 87	Nepeta x 'faassenii' 'Cats Meow'	Cats Meow Catmint	4.5" Cont.	24" o.c.	18 T x 30 W
	PR2 94	Paeonia lactiflora 'Karl Rosenfield'	Karl Rosenfield Chinese Peony	4.5" Cont.	20" o.c.	30 T x 24 W
	PT3 35	Pulmonaria x 'Trevi Fountain'	Lungwort	4.5" Cont.	15" o.c.	12 T x 18 W
	SR 8	Solidago rugosa 'Fireworks'	Fireworks Wrinkleleaf Goldenrod	4.5" Cont.	18" o.c.	36 T x 22 W

SYMBOL	QTY	BOTANICAL NAME	COMMON NAME	SIZE	SPACING	REMARKS
GROUND COVERS						
	9,456 sf	RAINWATER RENEWAL MIX	Agrecol Rainwater Renewal Seed Mix			
	14,667 sf	NO MOW TURF	Reinders No Mow/Low Grow Mix			
		Turf Hydroseed Low Grow				
AGRECOL MIXES						
	3,046 sf	AGRECOL SHORTGRASS PRAIRIE	AGRECOL SHORTGRASS PRAIRIE MIX			
	16,400 sf	AGRECOL TALLGRASS PRAIRIE	AGRECOL TALLGRASS PRAIRIE			
TURF						
	89,328 sf	Turf Hydroseed	Reinders - Cadet 70/30 Fescue/Blue Mix			

REFERENCE NOTES SCHEDULE

SYMBOL	CODE	DESCRIPTION	QTY
	1	ARTIFICIAL TURF	1,787 sf
	2	STONE MULCH MAINTENANCE STRIP	108 sf

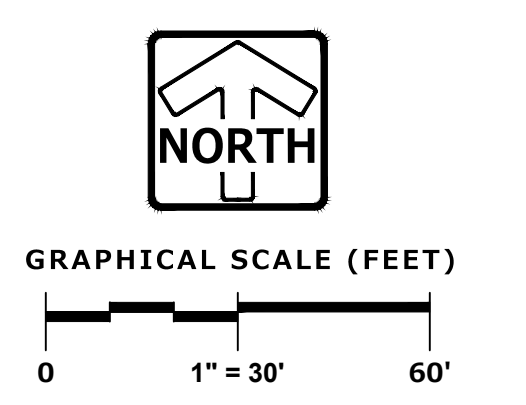

REVISIONS

NO.	DATE	DESCRIPTION

LANDSCAPE OVERVIEW
www.pinnacle-engr.com

DESIGNED: SAT
 CHECKED: SAT
 PLANNED: SAT
 DRAWN: SAT
 THESE PLANS AND DESIGNS ARE COPYRIGHT PROTECTED AND MAY NOT BE USED IN WHOLE OR IN PART WITHOUT THE WRITTEN CONSENT OF PINNACLE ENGINEERING GROUP, LLC
 Z:\PROJECTS\2024\6046-00-WI\CAD\SHEETS\6046-00-WI F STREET CALEDONIA LANDSCAPE PLAN.DWG

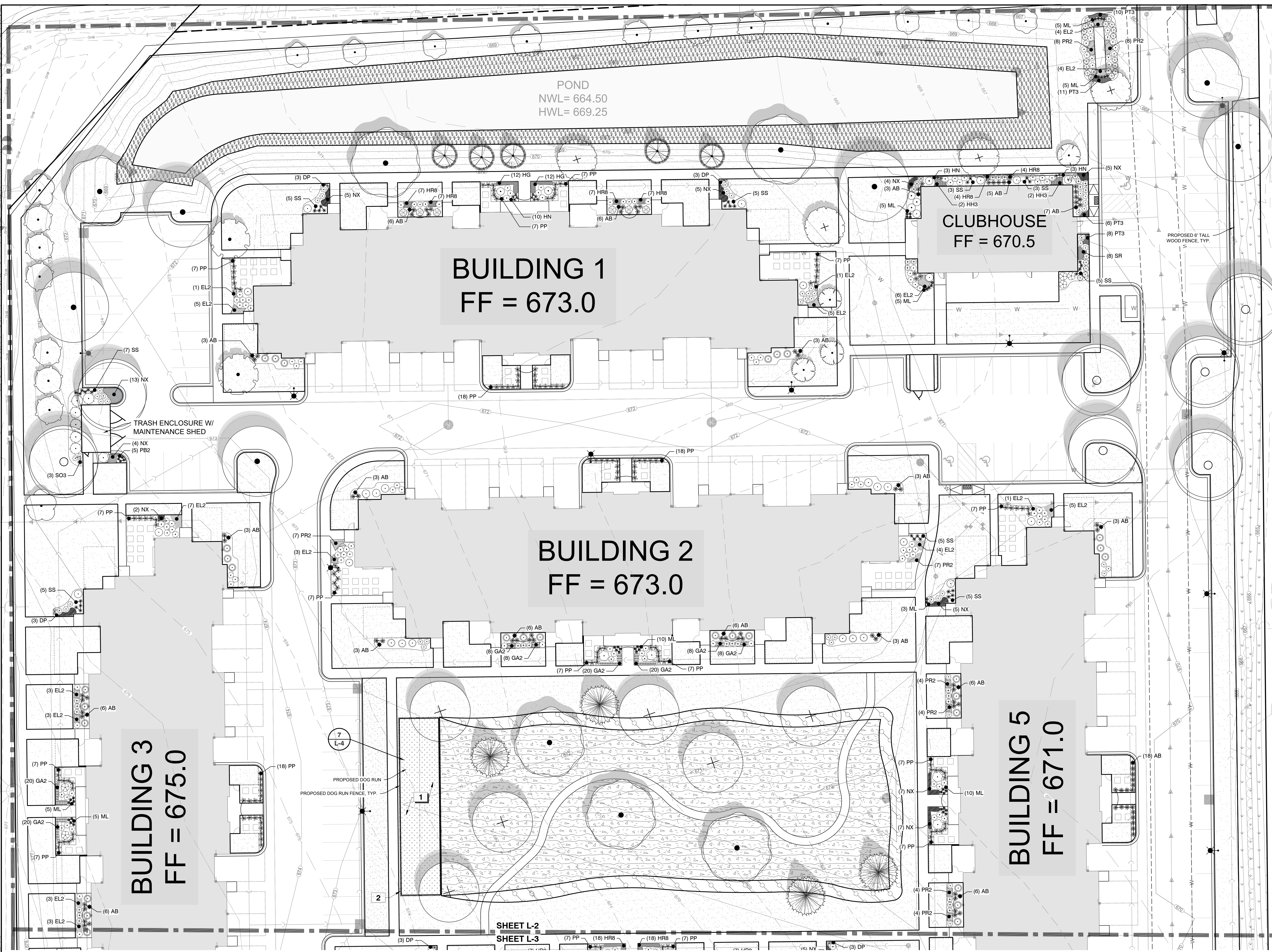

SYMBOL	BOTANICAL NAME	COMMON NAME
TREES		
	<i>Acer platanoides</i> 'Columnare'	Columnar Norway Maple
	<i>Acer platanoides</i> 'Emerald Queen'	Emerald Queen Maple
	<i>Celtis occidentalis</i> 'Chicagoland'	Chicagoland Hackberry
	<i>Celtis occidentalis</i> 'Prairie Sentinel'	Prairie Sentinel Hackberry
	<i>Ginkgo biloba</i> 'Fastigiata'	Fastigiata Maidenhair Tree
	<i>Liriodendron tulipifera</i> 'Emerald City'	Emerald City Tulip Tree
	<i>Platanus x acerifolia</i> 'Morton Circle'	Exclamation London Plane Tree
	<i>Ulmus x</i> 'Morton Glossy'	Triumph Elm
EVERGREEN TREES		
	<i>Picea glauca</i> 'Densata'	Black Hills Spruce
	<i>Pseudotsuga menziesii</i>	Douglas Fir
ORNAMENTAL TREES		
	<i>Carpinus caroliniana</i> 'JN Strain'	Fire King Muscledwood
	<i>Syringa reticulata</i> 'Summer Storm'	Summer Storm Tree Lilac
SHRUBS		
	<i>Cornus sanguinea</i> 'Anny's Winter Orange'	Anny's Winter Orange Dogwood
	<i>Cornus sericea</i> 'Bergeson's Compact'	Bergeson's Red Twig Dogwood
	<i>Cotinus coccinifolia</i> 'Lila'	Lila Dwarf Smoke Tree
	<i>Diervilla x</i> 'G2X8854'	Kodiak Orange Diervilla
	<i>Hydrangea paniculata</i> 'SMHPS'	Razzleberry™ Hydrangea
	<i>Philadelphus coronarius</i> 'Aureus'	Golden Mockorange
	<i>Syringa meyeri</i> 'Palibin'	Dwarf Korean Lilac
	<i>Syringa x</i> 'SMNURP'	Blooming Dwarf Pink Lilac
	<i>Weigela florida</i> 'Bokraspiwi'	Spilled Wine Weigela
EVERGREEN SHRUBS		
	<i>Juniperus chinensis</i> 'Ames'	Ames Juniper
	<i>Juniperus chinensis</i> 'Blue Vase'	Blue Vase Juniper
	<i>Juniperus horizontalis</i> 'Blue Forest'	Blue Forest Creeping Juniper
	<i>Pinus mugo pumilio</i>	Dwarf Mugo Pine
	<i>Pinus strobus</i> 'Blue Shag'	Blue Shag White Pine
	<i>Taxus x media</i> 'Herbs Low Dense'	Herbs Low Dense Yew
	<i>Taxus x media</i> 'SMATHDS'	Stonehenge Dark Druid® Yew
	<i>Thuja occidentalis</i> 'Hetz Midget'	Hetz Midget Arborvitae
	<i>Thuja occidentalis</i> 'Art Boe'	North Pole® Arborvitae
ORNAMENTAL GRASSES		
	<i>Andropogon gerardii</i> 'Blackhawk'	Blackhawk's Big Bluestem
	<i>Deschampsia cespitosa</i> 'Pixie Fountain'	Pixie Fountain Tufted Hair Grass
	<i>Hakonechloa macra</i> 'Nicoles'	Nicoles Japanese Forest Grass
	<i>Miscanthus sinensis</i> 'Little Kitten'	Little Kitten Eulalia Grass
	<i>Panicum virgatum</i> 'Prairie Sky'	Prairie Sky Switch Grass
	<i>Schizachyrium scoparium</i> 'Standing Ovation'	Standing Ovation Little Bluestem
PERENNIALS		
	<i>Dianthus gratianopolitanus</i> 'Firewitch'	Firewitch Cheddar Pink
	<i>Echinacea x</i> 'Balsomeymim' TM	Sombrero Lemon Yellow Improved Coneflower
	<i>Gaillardia aristata</i> 'Arizona Sun'	Arizona Sun Blanket Flower
	<i>Heuchera x</i> 'Georgia Peach'	Georgia Peach Coral Bells
	<i>Hosta sieboldiana</i> 'Northern Exposure'	Northern Exposure Hosta
	<i>Hosta x</i> 'Rainforest Sunrise'	Rainforest Sunrise Hosta
	<i>Nepeta x faassenii</i> 'Cat's Meow'	Cat's Meow Catmint
	<i>Paeonia lactiflora</i> 'Karl Rosenfield'	Karl Rosenfield Chinese Peony
	<i>Pulmonaria x</i> 'Trevi Fountain'	Lungwort
	<i>Soligado rugosa</i> 'Fireworks'	Fireworks Winkleaf Goldenrod
GROUND COVERS		
	RAINWATER RENEWAL MIX	
	Native Plantings	Agrecol Rainwater Renewal Seed Mix
	TURF	
	Turf Hydroseed	Reinders - Cadet 70/30 Fescue/Blue Mix
	NO MOW TURF	
	Turf Hydroseed Low Grow	Reinders No Mow/Low Grow Mix
AGRECOL MIXES		
	AGRECOL SHORTGRASS PRAIRIE	AGRECOL SHORTGRASS PRAIRIE
	AGRECOL TALLGRASS PRAIRIE	AGRECOL TALLGRASS PRAIRIE

REFERENCE NOTES KEY		
SYMBOL	CODE	DESCRIPTION
	1	ARTIFICIAL TURF
	2	STONE MULCH MAINTENANCE STRIP

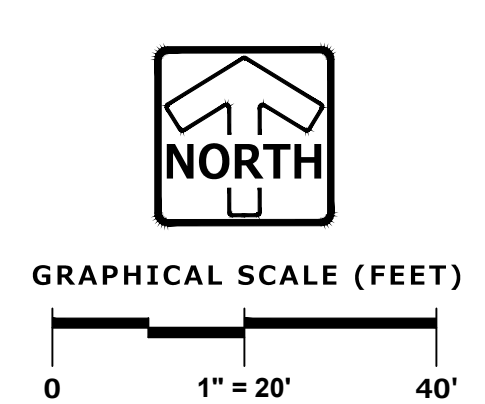

PINNACLE ENGINEERING GROUP
 ENGINEERING | NATURAL RESOURCES | SURVEYING
 CHICAGO | MILWAUKEE | WASHINGTON

PLAN | DESIGN | DELIVER
 www.pinnacle-engr.com

WISCONSIN OFFICE:
 20725 WATERTOWN ROAD, SUITE 100
 BROOKFIELD, WI 53106
 (262) 754-8888

F STREET CALEDONIA
LANDSCAPE ENLARGEMENT
CALEDONIA, WISCONSIN

LANDSCAPE ENLARGEMENT

REVISIONS		SHEET
NO.	DESCRIPTION	
		L-2 of L-4

www.pinnacle-engr.com
 LANDSCAPE ENLARGEMENT

DESIGNED: SAT
 CHECKED: SAT
 DRAFTED: SAT
 REVIEWED: SAB
 THESE PLANS AND DESIGNS ARE COPYRIGHT PROTECTED AND MAY NOT BE USED IN WHOLE OR IN PART WITHOUT THE WRITTEN CONSENT OF PINNACLE ENGINEERING GROUP, LLC

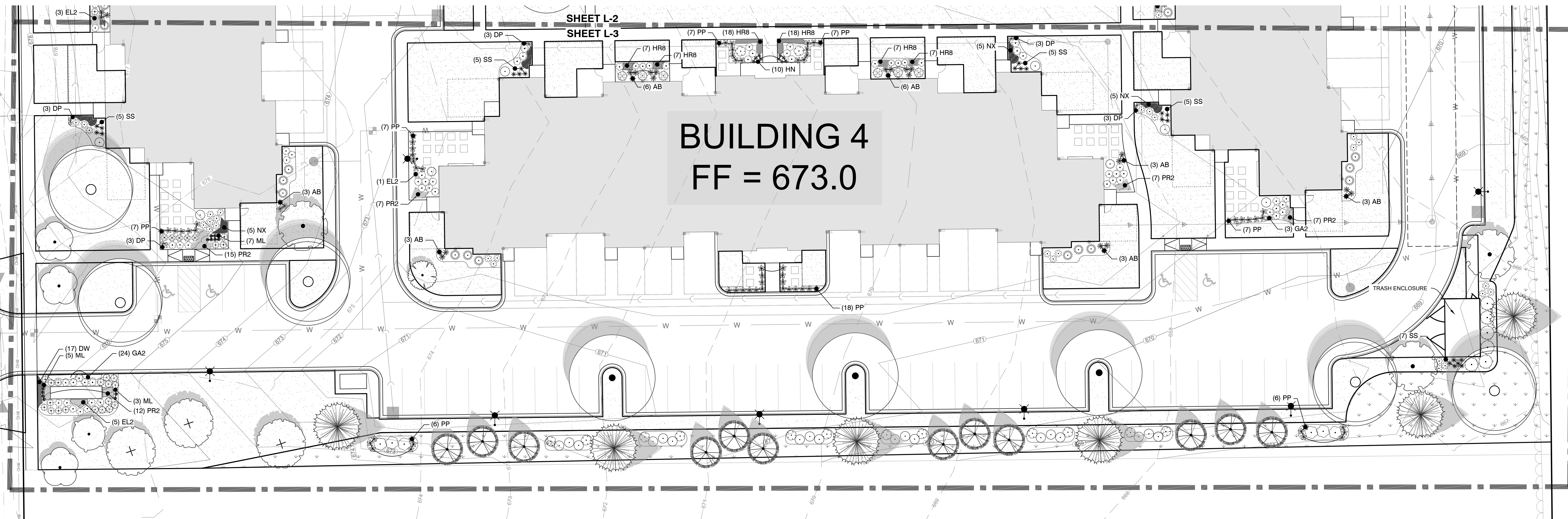

PLANT KEY

SYMBOL	BOTANICAL NAME	COMMON NAME
TREES		
	<i>Acer platanoides</i> 'Columnare'	Columnar Norway Maple
	<i>Acer platanoides</i> 'Emerald Queen'	Emerald Queen Maple
	<i>Celtis occidentalis</i> 'Chicagoland'	Chicagoland Hackberry
	<i>Celtis occidentalis</i> 'Prairie Sentinel'	Prairie Sentinel Hackberry
	<i>Ginkgo biloba</i> 'Fastigiata'	Fastigiata Maidenhair Tree
	<i>Liriodendron tulipifera</i> 'Emerald City'	Emerald City Tulip Tree
	<i>Platanus x acerifolia</i> 'Morton Circle'	Exclamation London Plane Tree
	<i>Ulmus x Morton Glossy</i>	Triumph Elm
EVERGREEN TREES		
	<i>Picea glauca</i> 'Densata'	Black Hills Spruce
	<i>Pseudotsuga menziesii</i>	Douglas Fir
ORNAMENTAL TREES		
	<i>Carpinus caroliniana</i> 'JN Strain'	Fire King Musclewood
	<i>Syringa reticulata</i> 'Summer Storm'	Summer Storm Tree Lilac

SHRUBS

	<i>Cornus sanguinea</i> 'Anny's Winter Orange'	Anny's Winter Orange Dogwood
	<i>Cornus sericea</i> 'Bergeson's Compact'	Bergeson's Red Twig Dogwood
	<i>Cotinus coggygria</i> 'Lilla'	Lilla Dwarf Smoke Tree
	<i>Diervilla x 'G2X85544'</i>	Kodiak Orange Diervilla
	<i>Hydrangea paniculata</i> 'SMHPS'	Razzeleberi™ Hydrangea
	<i>Philadelphus coronarius</i> 'Aureus'	Golden Mockorange
	<i>Syringa meyeri</i> 'Palibin'	Dwarf Korean Lilac
	<i>Syringa x 'SMNJRP1'</i>	Bloomerang Dwarf Pink Lilac
	<i>Weigela florida</i> 'Bokraspiw'	Spilled Wine Weigela

EVERGREEN SHRUBS

	<i>Juniperus chinensis</i> 'Ames'	Ames Juniper
	<i>Juniperus chinensis</i> 'Blue Vase'	Blue Vase Juniper
	<i>Juniperus horizontalis</i> 'Blue Forest'	Blue Forest Creeping Juniper
	<i>Pinus mugo pumilio</i>	Dwarf Mugo Pine
	<i>Pinus strobus</i> 'Blue Shag'	Blue Shag White Pine
	<i>Taxus x media</i> 'Herbs Low Dense'	Herbs Low Dense Yew
	<i>Taxus x media</i> 'SMNTHDB'	Stonehenge Dark Druid® Yew
	<i>Thuja occidentalis</i> 'Hetz Midget'	Hetz Midget Arborvitae
	<i>Thuja occidentalis</i> 'Art Boe'	North Pole® Arborvitae

ORNAMENTAL GRASSES

	<i>Andropogon gerardii</i> 'Blackhawks'	Blackhawks Big Bluestem
	<i>Deschampsia cespitosa</i> 'Pixie Fountain'	Pixie Fountain Tufted Hair Grass
	<i>Hakonechloa macra</i> 'Nicolas'	Nicolas Japanese Forest Grass
	<i>Miscanthus sinensis</i> 'Little Kitten'	Little Kitten Eulalia Grass
	<i>Panicum virgatum</i> 'Prairie Sky'	Prairie Sky Switch Grass
	<i>Schizachyrium scoparium</i> 'Standing Ovation'	Standing Ovation Little Bluestem

PERENNIALS

	<i>Dianthus gratianopolitanus</i> 'Firewitch'	Firewitch Cheddar Pink
	<i>Echinacea x 'Balsomeymim' TM</i>	Sombrero Lemon Yellow Improved Coneflower
	<i>Gaillardia aristata</i> 'Arizona Sun'	Arizona Sun Blanket Flower
	<i>Heuchera x 'Georgia Peach'</i>	Georgia Peach Coral Bells
	<i>Hosta sieboldiana</i> 'Northern Exposure'	Northern Exposure Hosta
	<i>Hosta x 'Rainforest Sunrise'</i>	Rainforest Sunrise Hosta
	<i>Nepeta x 'faassenii</i> 'Cat's Meow'	Cat's Meow Catmint
	<i>Paeonia lactiflora</i> 'Karl Rosenfield'	Karl Rosenfield Chinese Peony
	<i>Pulmonaria x 'Trevi Fountain'</i>	Lungwort
	<i>Solidago rugosa</i> 'Fireworks'	Fireworks Winkleleaf Goldenrod

GROUND COVERS

	RAINWATER RENEWAL MIX	
	Native Plantings	Agrecol Rainwater Renewal Seed Mix
	TURF	
	Turf Hydroseed	Reinders - Cadet 70/30 Fescue/Blue Mix
	NO MOW TURF	
	Turf Hydroseed Low Grow	Reinders No Mow/Low Grow Mix

AGRECOL MIXES

	AGRECOL SHORTGRASS PRAIRIE	AGRECOL SHORTGRASS PRAIRIE MIX
	AGRECOL TALLGRASS PRAIRIE	AGRECOL TALLGRASS PRAIRIE

REFERENCE NOTES KEY

SYMBOL	CODE	DESCRIPTION
	1	ARTIFICIAL TURF
	2	STONE MULCH MAINTENANCE STRIP



GRAPHICAL SCALE (FEET)
 0 1" = 20' 40'

F STREET CALEDONIA
CALEDONIA, WISCONSIN

LANDSCAPE ENLARGEMENT (2)

REVISIONS

NO.	DATE	DESCRIPTION

PRG JOB NO. 6046.00
 A/E/K
 START DATE 12/23/25
 SCALE 1" = 20'

SHEET
L-3
 of
L-4

GENERAL PLANTING NOTES

- THE LAYOUT OF ALL PLANTING BEDS AND INDIVIDUAL TREES AND SHRUBS SHALL BE STAKED BY THE CONTRACTOR IN ADVANCE OF INSTALLATION. FLAGGING, STAKES, OR PAINT MAY BE USED TO DELINEATE LOCATIONS AS SCALED FROM THE PLANS. AN APPROVED REPRESENTATIVE WILL REVIEW THESE LOCATIONS WITH THE CONTRACTOR AND MAKE MINOR ADJUSTMENTS AS NECESSARY. BED LOCATION SHALL ALSO INCLUDE PERENNIAL GROUPINGS BY SPECIES.
- THE CONTRACTOR IS RESPONSIBLE FOR INDEPENDENTLY DETERMINING THE PLANT MATERIAL QUANTITIES REQUIRED BY THE LANDSCAPE PLANS. REPORT ANY DISCREPANCIES TO THE LANDSCAPE ARCHITECT.
- NO PLANT MATERIAL OR PLANT SIZE SUBSTITUTIONS WILL BE ACCEPTED WITHOUT APPROVAL BY THE LANDSCAPE ARCHITECT. ANY CHANGES SHALL BE SUBMITTED TO THE LANDSCAPE ARCHITECT IN WRITING PRIOR TO INSTALLATION.
- ALL BNB STOCK SHALL BE NURSERY GROWN IN A CLAY LOAM SOIL FOR A MINIMUM OF THREE GROWING SEASONS WITHIN 200 MILES OF PROJECT LOCATION, IN A ZONE COMPATIBLE WITH USDA HARDINESS ZONE 5A. SEED SHALL BE PROVIDED FROM A NURSERY (WITHIN 200 MILES) WITH A SIMILAR PLANT HARDINESS ZONE AS PROJECT LOCATION. EXISTING SOIL SHALL BE AMENDED PER SOIL ANALYSIS REPORT TO ENSURE A PROPER GROWING MEDIUM IS ACHIEVED.
- ALL PLANT MATERIAL SHALL COMPLY WITH STANDARDS DESCRIBED IN AMERICAN STANDARD OF NURSERY STOCK - Z60.1 ANSI. LANDSCAPE ARCHITECT OR OWNERS AUTHORIZED REPRESENTATIVE RESERVES THE RIGHT TO INSPECT AND POTENTIALLY REJECT ANY PLANT MATERIAL DEEMED TO NOT MEET THE REQUIRED STANDARDS.
- ALL STOCK SHALL BE FREE OF DISEASES AND HARMFUL INSECTS, DAMAGE, DISORDERS AND DEFORMITIES.
- TREES SHALL HAVE SINGLE, STRAIGHT TRUNKS AND WELL BALANCED BRANCH SYSTEMS. MULTI-STEM TREES SHALL HAVE 3-4 STRAIGHT TRUNKS AND WELL BALANCED BRANCH SYSTEMS. HEIGHT-TO-CALIPER RATIOS SHALL BE CONSISTENT WITH THE LATEST EDITION OF ANSI Z60.1.
- ROOT SYSTEMS SHALL BE LARGE ENOUGH TO ALLOW FOR FULL RECOVERY OF THE TREE, AND SHALL CONFORM TO STANDARDS AS THEY APPEAR IN THE MOST CURRENT REVISION OF THE AMERICAN ASSOCIATION OF NURSERYMEN'S AMERICAN STANDARD OF NURSERY STOCK ANSI Z60.1.
- BNB TREES SHALL BE DUG WITH A BALL OF SOIL, NOT SOFT BALLED OR POTTED AND SHALL BE FIRM IN THEIR ROOTBALL. ROOT BALL SHALL BE WRAPPED (WITH BIODEGRADABLE MATERIAL). THE TREE ROOT FLARE, OR COLLAR, SHALL BE AT OR WITHIN THE TOP THREE INCHES OF GRADE.
- ALL SPRING TREES MUST BE FRESHLY DUG IN THE MOST RECENT SPRING.
- ALL AUTUMN TREES MUST BE FRESHLY DUG IN THE MOST RECENT AUTUMN.
- TREES SHALL BE ALIVE, HEALTHY AND APPROPRIATELY MOIST, AT TIME OF DELIVERY. TREES SHALL BE SUBJECT TO INSPECTION FOR CONFORMITY TO SPECIFICATION REQUIREMENTS AND APPROVAL BY THE LANDSCAPE ARCHITECT OR OWNERS REPRESENTATIVE. THE LANDSCAPE ARCHITECT OR OWNERS REPRESENTATIVE RESERVES THE RIGHT TO REJECT ANY TREES THAT DO NOT MEET THE SPECIFICATIONS OR THAT HAVE BEEN DAMAGED DURING SHIPMENT. THE LANDSCAPE INSTALLER MUST RECEIVE APPROVAL FROM LANDSCAPE ARCHITECT FOR ANY SUBSTITUTIONS OR ALTERATIONS.
- ALL PLANT MATERIAL SHALL BE INSTALLED IN ACCORDANCE WITH PLANTING DETAILS.
- ALL PLANTING BEDS SHALL HAVE A MINIMUM 10" DEPTH OF PREPARED SOIL. WITH APPROVAL, EXISTING SOIL MAY BE UTILIZED PROVIDED THE PROPER SOIL AMENDMENTS ARE TILLED THOROUGHLY INTO THE TOP 10" OF SOIL. REFER TO SOIL PLACEMENT NOTES.
- WHILE PLANTING TREES AND SHRUBS, BACKFILL 2/3 OF PLANTING HOLE AND WATER TREE THOROUGHLY BEFORE INSTALLING THE REMAINDER OF SOIL MIXTURE. AFTER ALL TREE HAS BEEN PLACED INTO THE PLANTING HOLE WATER THOROUGHLY AGAIN.
- THE CONTRACTOR MUST LABEL ALL TREES WITH THE COMMON AND BOTANICAL NAMES PRIOR TO FINAL INSPECTION.
- ALL PLANTING BEDS SHALL BE MULCHED WITH 3" DEEP SHREDDED HARDWOOD MULCH, AND ALL TREES PLANTED IN TURF AREAS SHALL RECEIVE A 3" DEEP SHREDDED HARDWOOD MULCHED RING AS SHOWN IN PLANTING DETAILS.
- ALL PLANTING BEDS AND TREE RINGS SHALL HAVE A 4" DEEP TRENCHED BED EDGE CREATED BY EITHER A FLAT LANDSCAPE SPADE OR MECHANICAL EDGER. BED EDGES ARE TO BE CUT CLEAN AND SMOOTH AS SHOWN ON LANDSCAPE PLANS WITH A CLEAR DEFINITION BETWEEN TURF AND PLANTING AREAS.
- ALL AREAS RECEIVING STONE MULCH TO RECEIVE STEEL BED EDGING. CONTRACTOR TO PROVIDE STEEL EDGING SPECIFICATION FOR APPROVAL PRIOR TO INSTALLATION. STEEL EDGING TO BE INSTALLED PER MANUFACTURERS RECOMMENDATION.
- AREAS THAT CALL FOR STONE MULCH SHALL RECEIVE LANDSCAPE FABRIC WITH 4" DEEP ALPINE STONE MULCH. REFER TO STONE MULCH DETAILS. CONTRACTOR TO PROVIDE LANDSCAPE FABRIC AND MULCH SPECIFICATIONS TO LANDSCAPE ARCHITECT FOR APPROVAL PRIOR TO INSTALLATION. LANDSCAPE FABRIC SHALL BE INSTALLED TO COVER THE ENTIRE AREA TO RECEIVE STONE MULCH WITH EACH SEAM OVERLAPPING A MINIMUM OF 6".
- ALL TURF SEED AREAS SHALL RECEIVE A MINIMUM OF 6" DEPTH OF TOPSOIL. WITH APPROVAL, EXISTING SOIL MAY BE UTILIZED PROVIDED THE PROPER SOIL AMENDMENTS ARE TILLED THOROUGHLY INTO THE TOP 6" OF SOIL AS INDICATED IN THE SOIL PLACEMENT NOTES. REQUIRED AMENDMENTS SHALL BE DETERMINED BASED ON A SOIL ANALYSIS TO BE PERFORMED. ALL TOPSOIL AMENDMENT SHALL BE AGED WEED FREE MANURE OR CLASS 1 ORGANIC MATTER.
- FOR LAWN SEEDING, APPLY A STARTER FERTILIZER AND SEED UNIFORMLY AT THE RATE RECOMMENDED BY MANUFACTURER, AND PROVIDE A MULCH COVERING THAT IS SUITABLE TO PROMOTE SEED GERMINATION AND TURF ESTABLISHMENT. CONTRACTOR TO PROVIDE FERTILIZER, SEED, AND MULCH SPECIFICATIONS TO THE LANDSCAPE ARCHITECT FOR APPROVAL PRIOR TO INSTALLATION. EROSION CONTROL MEASURES ARE TO BE INSTALLED IN THOSE AREAS REQUIRING STABILIZATION (SWALES, SLOPES EXCEEDING 1:3, AND THOSE LOCATIONS INDICATED IN CIVIL DRAWINGS).
- THE CONTRACTOR TO ENSURE A SMOOTH, UNIFORM QUALITY TURF IS ACHIEVED WITH NO BARE SPOTS LARGER THAN 6" X 6". ANY BARE SPOTS LARGER THAN 6" X 6" AT THE END OF ESTABLISHMENT PERIOD SHALL BE RESEED AT THE CONTRACTORS EXPENSE TO OBTAIN A DENSE, UNIFORM LAWN.
- ALL FINISH GRADING AND LAWN AREAS TO BE INSTALLED BY LANDSCAPE CONTRACTOR.
- ALL DISTURBED AREAS WITHIN THE PROJECT SHALL BE RESTORED TO ORIGINAL OR BETTER CONDITION.
- ALL DISTURBED AREAS OUTSIDE THE LIMITS OF WORK SHALL BE RESTORED TO ORIGINAL OR BETTER CONDITION AT NO ADDITIONAL COST TO THE OWNER.
- THE CONTRACTOR SHALL VERIFY ALL EXISTING UTILITIES, INCLUDING ANY IRRIGATION LINES, PRIOR TO DIGGING. CONSULT DIGGERS HOTLINE.
- TREES SHALL BE INSTALLED NO CLOSER THAN:
 - 10 FEET FROM ANY FIRE HYDRANT
 - 7 FEET FROM STORM SEWER, SANITARY SEWER LATERALS, DRIVEWAYS, AND WATER SERVICE
- THE CONTRACTOR SHALL ENSURE THAT SOIL CONDITIONS AND COMPACTION ARE ADEQUATE TO ALLOW FOR PROPER DRAINAGE AROUND THE CONSTRUCTION SITE. UNDESIRABLE CONDITIONS SHALL BE BROUGHT TO THE ATTENTION OF THE LANDSCAPE ARCHITECT PRIOR TO BEGINNING OF WORK. IT SHALL BE THE CONTRACTOR'S RESPONSIBILITY TO ENSURE PROPER SURFACE AND SUBSURFACE DRAINAGE IN ALL AREAS
- THE CONTRACTOR IS RESPONSIBLE FOR ALL PERMITS, FEES, AND LICENSES NECESSARY FOR THE INSTALLATION OF THIS PLAN.
- THE CONTRACTOR IS TO REVIEW ALL SITE ENGINEERING DOCUMENTS PRIOR TO INSTALLATION. ANY CONFLICTS MUST BE REPORTED TO THE LANDSCAPE ARCHITECT. THESE LANDSCAPE DRAWINGS ARE FOR THE INSTALLATION OF PLANT MATERIALS ONLY UNLESS OTHERWISE STATED.
- THE CONTRACTOR SHALL PROVIDE WATERING AND MAINTENANCE SERVICES FOR A PERIOD OF 60 DAYS TO ENSURE VEGETATIVE ESTABLISHMENT. UPON COMPLETION OF THE PROJECT, CONTRACTOR SHALL SUPPLY THE OWNER IN WRITING WITH ONGOING WATERING AND MAINTENANCE INSTRUCTIONS.

- PLANT MATERIALS SHALL BE GUARANTEED FOR A PERIOD OF ONE (1) YEAR FROM TIME OF OWNER ACCEPTANCE. ONLY ONE REPLACEMENT PER PLANT WILL BE REQUIRED DURING THE WARRANTY PERIOD EXCEPT IN THE EVENT OF FAILURE TO COMPLY WITH THE SPECIFIED REQUIREMENTS.
- THE CONTRACTOR IS RESPONSIBLE TO CONDUCT A FINAL WALK THROUGH WITH THE LANDSCAPE ARCHITECT AND OR OWNERS REPRESENTATIVE TO ANSWER QUESTIONS, PROVIDE INSTRUCTIONS, AND ENSURE THAT PROJECT REQUIREMENTS HAVE BEEN MET.

SOIL PLACEMENT NOTES

- LOOSEN SUBGRADE TO A MINIMUM DEPTH INDICATED IN PLANTING NOTES USING A CULTI-MULCHER OR SIMILAR EQUIPMENT, AND REMOVE STONES MEASURING OVER 1-1/2 INCHES IN ANY DIMENSION. STICKS, RUBBISH AND OTHER EXTRANEOUS MATTER. AREAS ADJACENT TO WALKS AND PAVEMENT SHALL BE FREE OF EXCESS STONE AND PAVING MATERIALS SO AS TO PROVIDE AN UNINTERRUPTED CROSS SECTION OF SOIL. INTERNAL PARKING ISLANDS SHALL BE LOOSENED TO A DEPTH OF 30".
- THOROUGHLY BLEND PLANTING SOIL MIX FOR PLANTING BED AREAS. (1 PART EXISTING SOIL, 1 PART TOPSOIL, 1 PART ORGANIC SOIL AMENDMENT, 2.9 POUNDS PER CUBIC YARD OF 4-4-4 ANALYSIS SLOW-RELEASE FERTILIZER)
- TREE AND SHRUB HOLES SHALL BE FILLED WITH A PREPARED PLANTING MIXTURE OF 1 PART TOPSOIL, 2 PARTS PLANTING SOIL MIX.
- SPREAD SOIL AND SOIL AMENDMENTS TO DEPTH INDICATED ON DRAWINGS, BUT NOT LESS THAN REQUIRED TO MEET FINISH GRADES AFTER NATURAL SETTLEMENT. (FINISH GRADE OF PLANTING BEDS SHALL BE 3" BELOW ALL ADJACENT SURFACES. FINISH GRADE OF TURF SEEDING AREAS SHALL BE 1" BELOW ALL ADJACENT HARD SURFACES, WALKS, AND CURBS.)
- PLACE APPROXIMATELY 1/2 OF TOTAL AMOUNT OF SOIL REQUIRED, WORK INTO TOP OF LOOSENED SUBGRADE TO CREATE A TRANSITION LAYER, THEN PLACE REMAINDER OF THE SOIL. SOIL TRANSITION LAYER SHALL BE TILLED TO A MINIMUM DEPTH OF 6" BELOW THE DEPTH OF HEAVILY PLACED SOIL. PARKING LOT ISLANDS SHALL BE CROWNED TO A HEIGHT OF 6" TO PROVIDE PROPER DRAINAGE UNLESS OTHERWISE NOTED.
- DO NOT SPREAD IF PLANTING SOIL OR SUBGRADE IS FROZEN, MUDDY, OR EXCESSIVELY WET.
- FINISH GRADING: GRADE SOIL TO A SMOOTH, UNIFORM SURFACE PLANE WITH A LOOSE, UNIFORMLY FINE TEXTURE.
- ROLL AND RAKE, REMOVE RIDGES, AND FILL DEPRESSIONS TO MEET FINISH GRADES.
- RESTORE PLANTING BEDS IF ERODED OR OTHERWISE DISTURBED AFTER FINISH GRADING AND BEFORE PLANTING.

NATIVE SEEDING

- ESTABLISHMENT OF A VIABLE VEGETATION COMMUNITY WILL BE COMPLETED BY HAND-BROADCASTING OF PRE-DESIGNED SEED MIXES TO CREATE A DYNAMIC PLANTING.
- PRIOR TO SEEDING:**
- ALL WEEDS AND EXISTING VEGETATION SHALL BE REMOVED. EXISTING VEGETATION SHALL BE TREATED WITH GLYPHOSATE OR SIMILAR HERBICIDE BY A LICENSED PROFESSIONAL. TREATMENT SHALL OCCUR A MINIMUM OF 10 DAYS PRIOR TO SEEDING. VEGETATION STILL ALIVE AFTER INITIAL HERBICIDE TREATMENT SHALL BE TREATED A SECOND TIME PRIOR TO TILLING INTO THE SOIL. TREATED VEGETATION SHALL BE TILLED INTO THE SOIL NO EARLIER THAN 1 DAY PRIOR TO SEEDING.
 - PREPARATION OF SOIL PRIOR TO SEEDING
 - REFER TO CIVIL PLANS FOR SOIL MIXTURE.
 - ALL FOREIGN MATERIALS LARGER THAN 1-INCH SHALL BE REMOVED FROM THE SOIL PRIOR TO SEEDING OR PLANTING.
 - AREA SHOULD BE FREE FROM UNSIGHTLY VARIATIONS, RIDGES, AND DEPRESSIONS.
 - AVOID DRIVING OVER THE SPECIFIED AREA WITH MACHINERY.

SPECIFICATIONS FOR HAND BROADCASTING:

- SEEDING SHALL BE CONDUCTED IN LATE FALL (SEPTEMBER 1- SOIL FREEZE) SO THAT SEEDS MAY LIE DORMANT DURING THE WINTER, ALLOWING FOR STRATIFICATION, OR SPRING (MARCH 1-JUNE 1) TO ALLOW A COMPLETE GROWING SEASON TO BECOME ESTABLISHED.
- COVER CROP**
 - ANNUAL RYE SHALL BE SPREAD AT A DENSITY OF 20 POUNDS PER ACRE DURING THE PLANTING OR SEEDING OF THE NATIVE PLANT SPECIES TO STABILIZE THE SOIL, AND REDUCE THE GROWTH OF UNWANTED VEGETATION. THIS ANNUAL GRASS GROWS RAPIDLY WITHOUT COMPETING WITH THE WILDFLOWERS AND GRASSES THAT ARE PLANTED IN THE TARGET AREAS.
 - WINTER WHEAT OR PERENNIAL RYE SHALL NOT BE USED AS A COVER CROP. THESE GRASSES MAY OUT COMPETE PRAIRIE SEEDLINGS, LEADING TO A REDUCTION IN THE SUCCESS OF THE PLANTINGS.
 - SEED MIX:**
 - MIX ALL NATIVE SEED WITH VERMICULITE ACCORDING TO AGRECOL RECOMMENDATIONS AND INSTALLATION GUIDELINES.
 - BROADCAST HALF THE SEED OVER THE ENTIRE SITE OR TARGET AREA.
 - BROADCAST THE OTHER HALF OF SEED PERPENDICULAR TO THE DIRECTION THAT THE FIRST HALF OF THE SEED WAS BROADCAST.
 - COVER SEED WITH 1/4-INCH TO 1/2-INCH OF SOIL (USE ANY EXCESS SOIL FROM THE SITE) WITH RAKE OR DRAG.
 - ROLL SITE TO ENSURE FIRM SEED-TO-GROUND CONTACT.
 - KEEP SEED CONSTANTLY WET THROUGH GERMINATION PERIOD. GENERALLY 3 WEEKS.

- ALL SEEDING SHALL BE COVERED WITH 1-INCH OF CLEAN, NON-INVASIVE STRAW (NO MARSH HAY, OR REED CANARY GRASS) WITHOUT SEEDS, WITHIN SEVEN DAYS. WHEAT, RYE, OATS, OR BARLEY ARE ACCEPTABLE FORMS OF STRAW. THOSE AREAS OF SLOPES STEEPER THAN 8:1 (EIGHT FEET HORIZONTAL TO ONE FOOT VERTICAL) SHALL BE PLANTED NO LATER THAN OCTOBER 1 AND STAKED WITH AN EROSION CONTROL BLANKET TO PREVENT EROSION.

NATIVE PLANTINGS:

- WEED SUPPRESSION MEASURES:**
- 1st YEAR** - PERFORM SPOT SPRAY WITH HERBICIDE TO SUPPRESS WEEDS. THIS SHOULD OCCUR APPROXIMATELY EVERY MONTH OF THE GROWING SEASON AFTER NATIVE PLANTINGS HAVE BEEN ROUGH GRADED.
- 2nd YEAR** - IN MAY/JUNE MOW NATIVE PLANTINGS AT 6" HEIGHT TO SUPPRESS THE WEEDS. PERFORM SPOT SPRAY WITH HERBICIDE TO SUPPRESS WEEDS. HAVE PROFESSIONAL ASSESS PLANTINGS. REPEAT MOWING NATIVE PLANTINGS AND SPOT-SPRAY IN EARLY JULY.
- 3rd YEAR** - IN MAY/JUNE MOW NATIVE PLANTINGS AT 8" HEIGHT TO SUPPRESS THE WEEDS. PERFORM SPOT SPRAY WITH HERBICIDE TO SUPPRESS WEEDS.
- 4th YEAR** - IN MAY PERFORM A PRESCRIBED BURN. IN JUNE HAVE A QUALIFIED PROFESSIONAL ASSESS PLANTINGS. IF A PRESCRIBED BURN CAN NOT BE UTILIZED, NATIVE PLANTINGS SHALL BE CUT TO THE GROUND AND ALL CUT MATERIAL SHALL BE REMOVED AND DISPOSED OF OFF SITE.

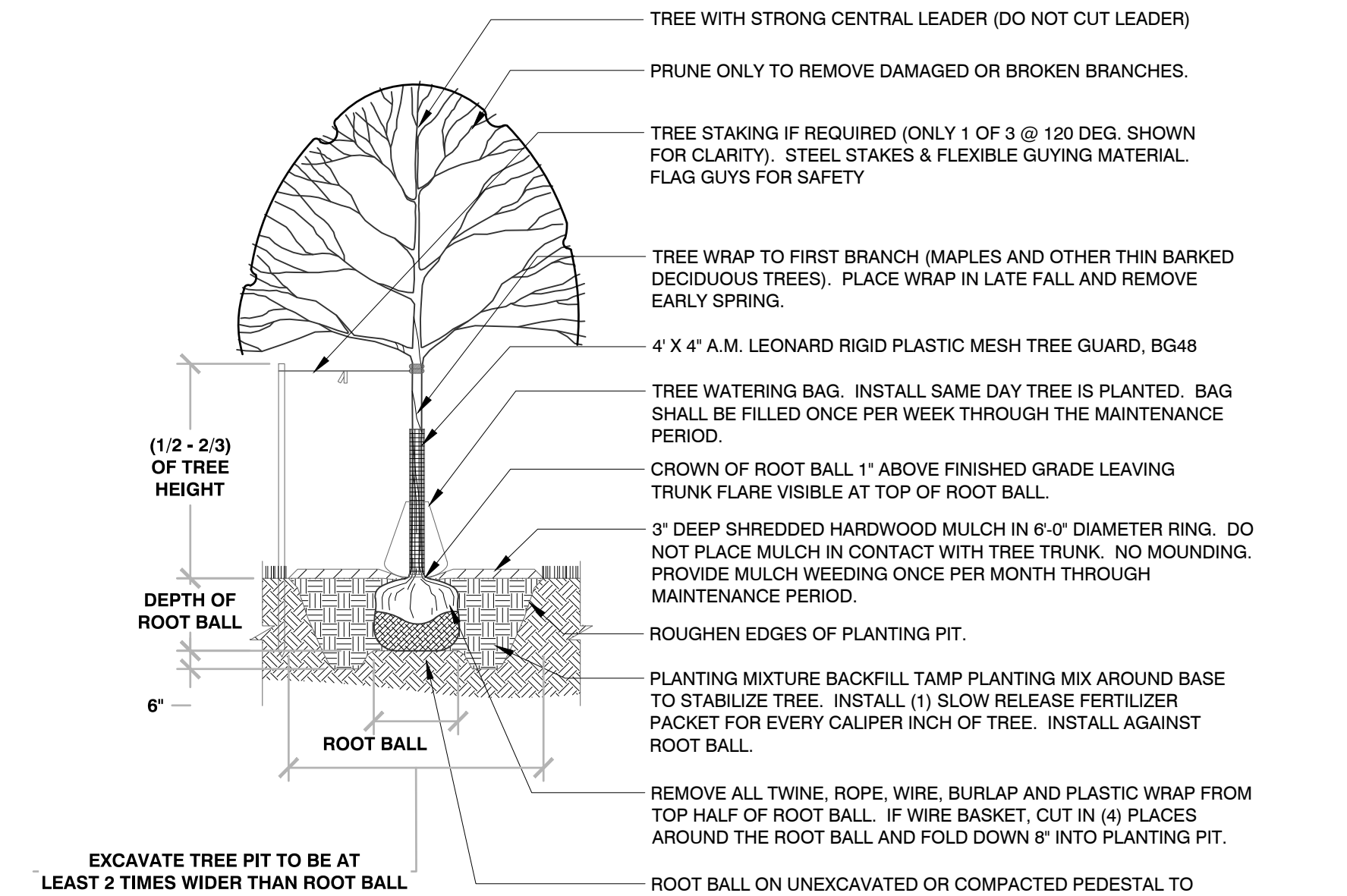

1 TREE PLANTING
1/4" = 1'-0"
329943-01

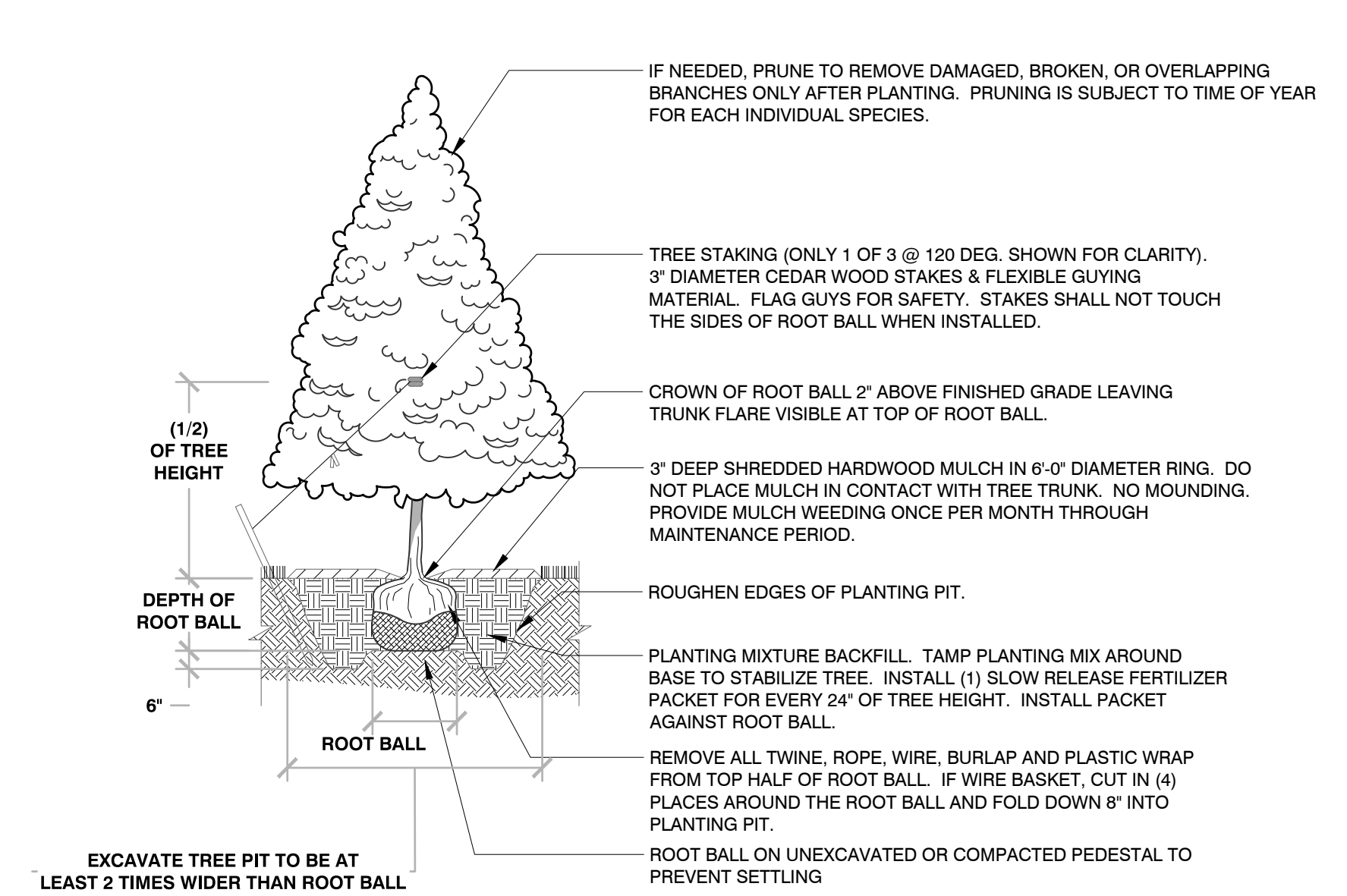

2 EVERGREEN TREE PLANTING
1/4" = 1'-0"
329943-03

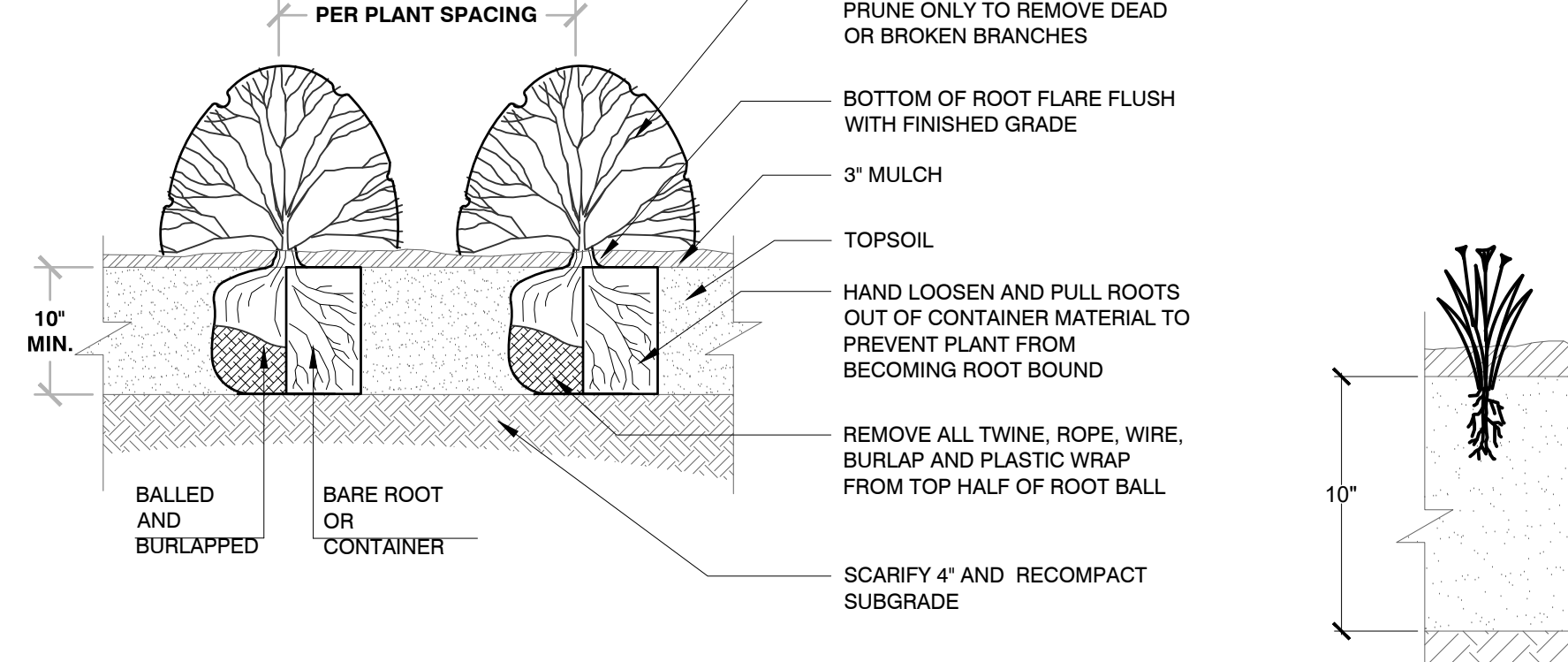

3 SHRUB PLANTING
1/2" = 1'-0"
329933-02

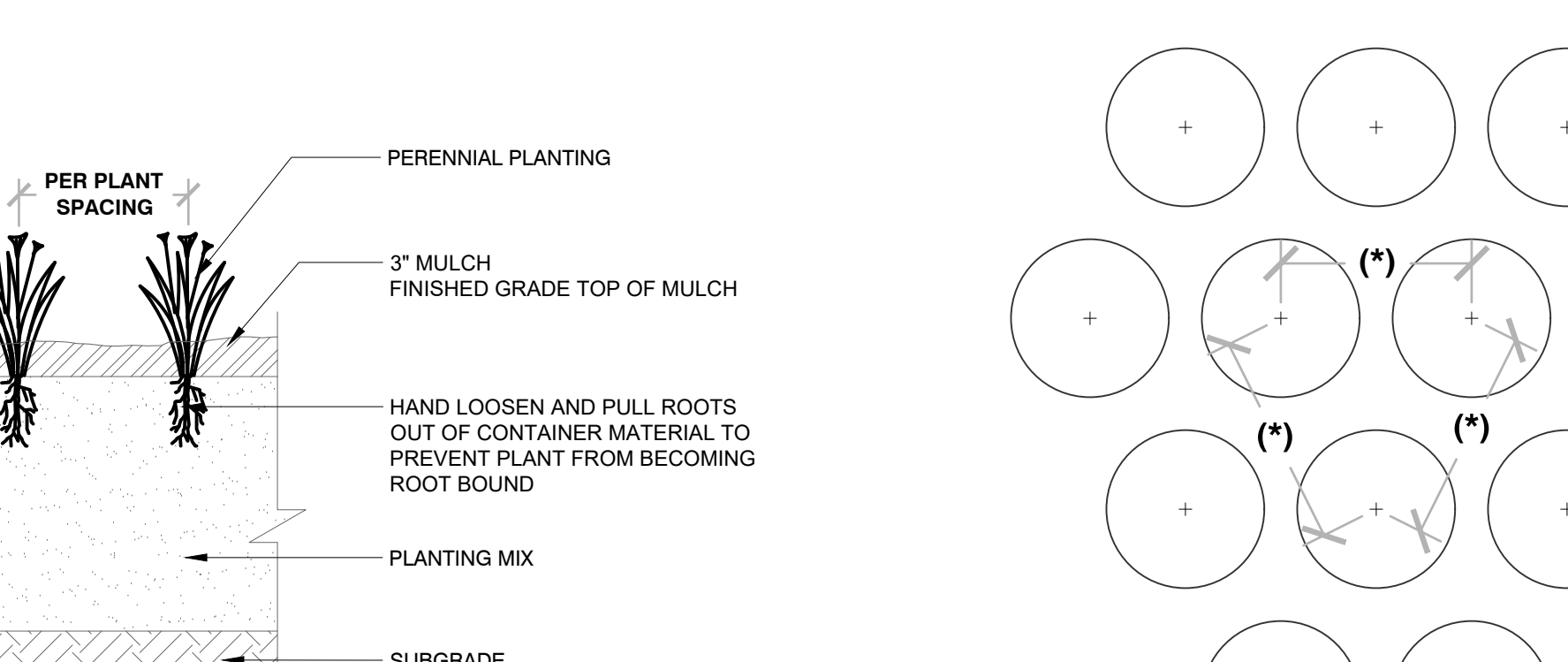

4 PERENNIAL PLANTING
1" = 1'-0"
3299-01

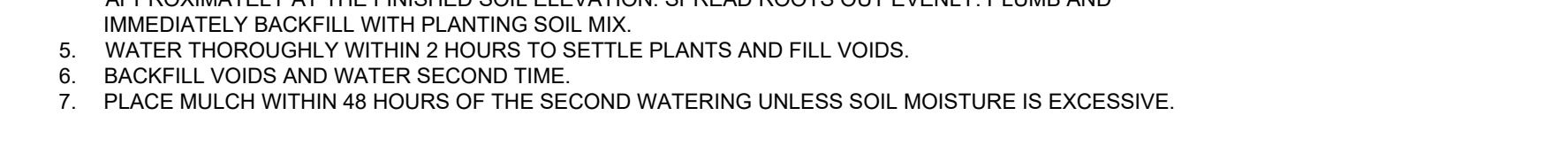
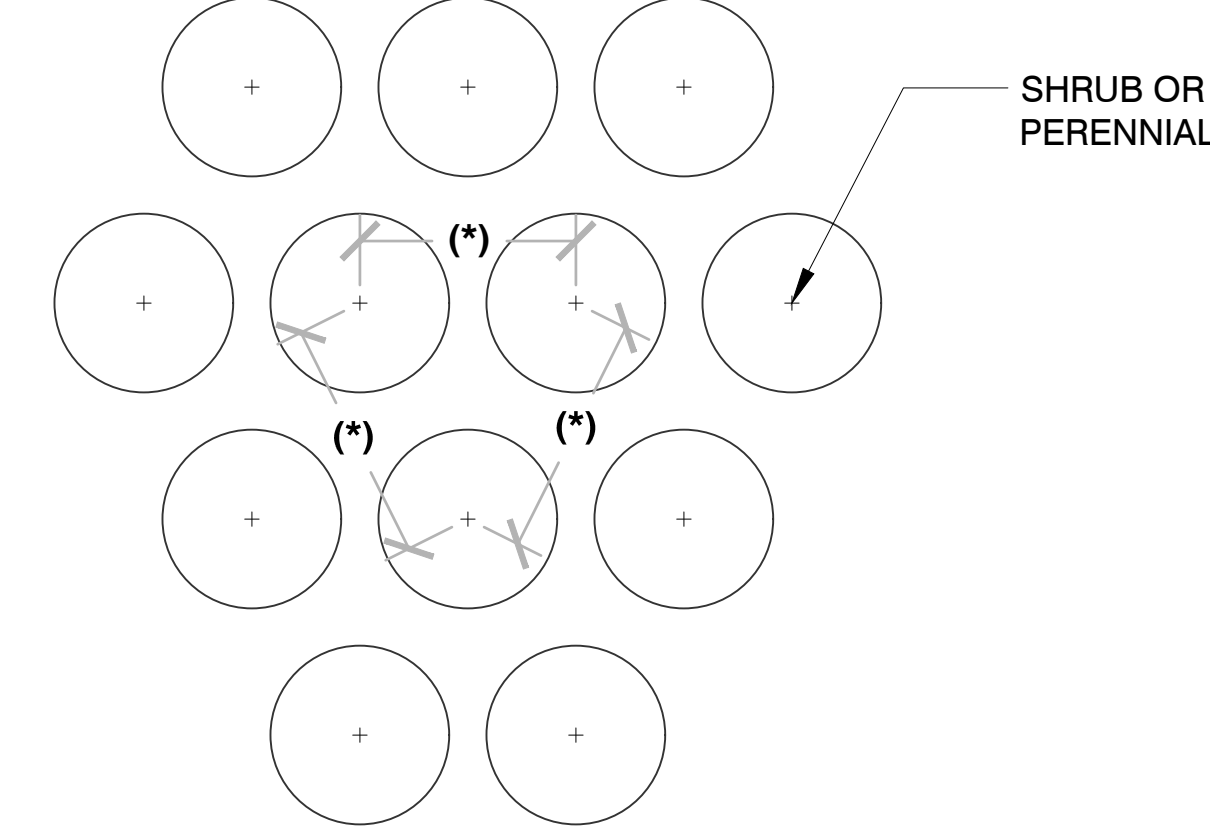

6 TRENCHED BED EDGE
3/4" = 1'-0"
3299-03



7 DOG RUN DETAIL
1/4" = 1'-0"
32313-02

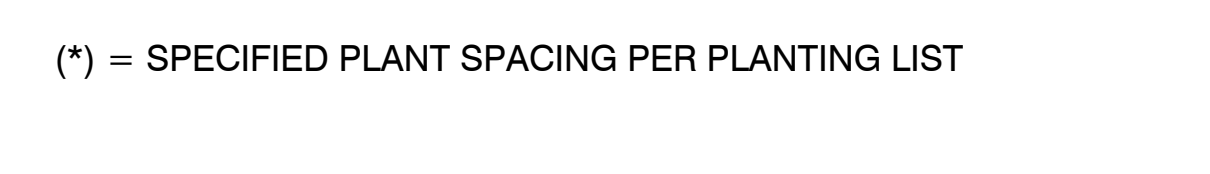

8 6\"/>

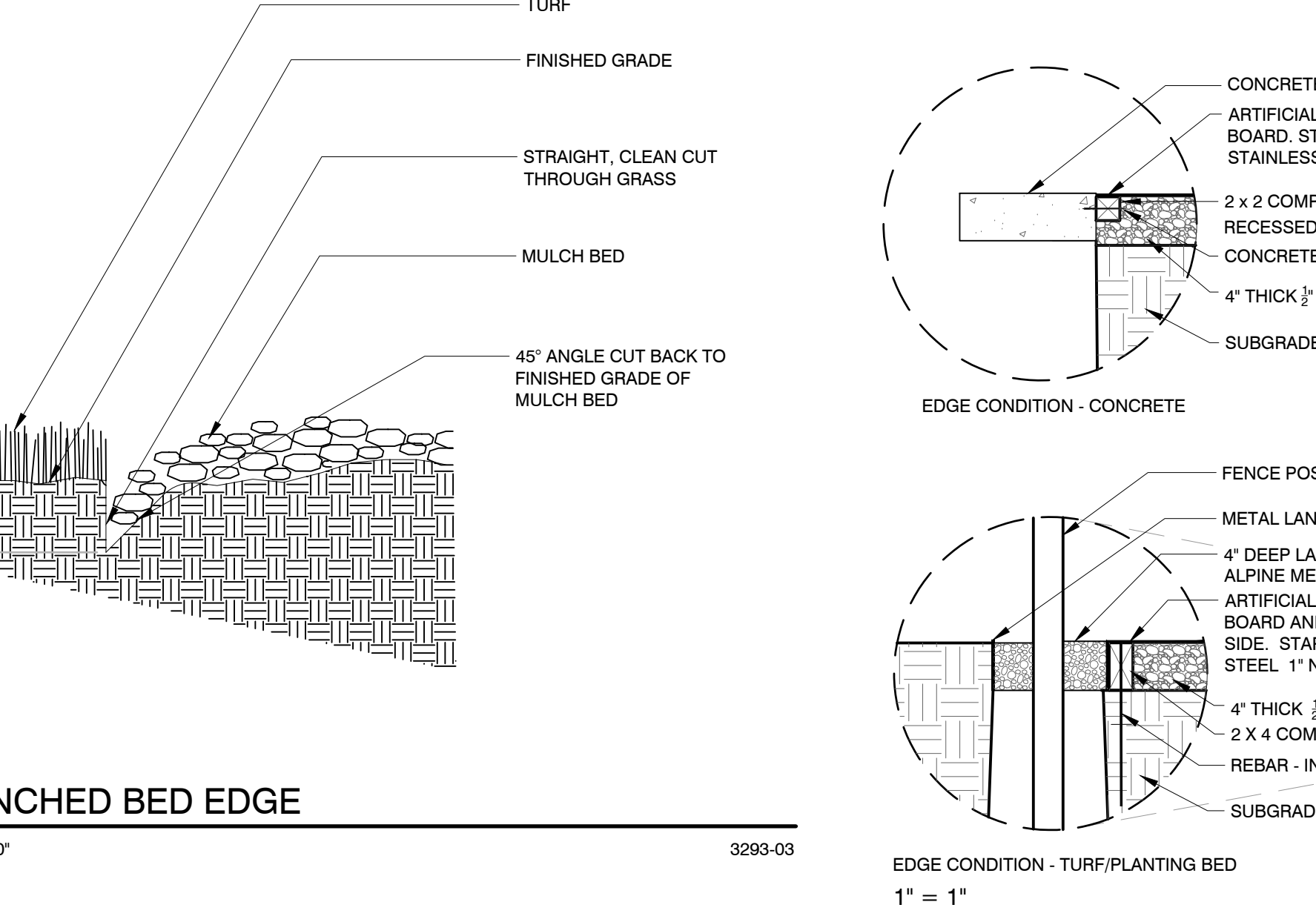

9 CRUSHED GRANITE PATHWAY
3/4" = 1'-0"
32 1543-03

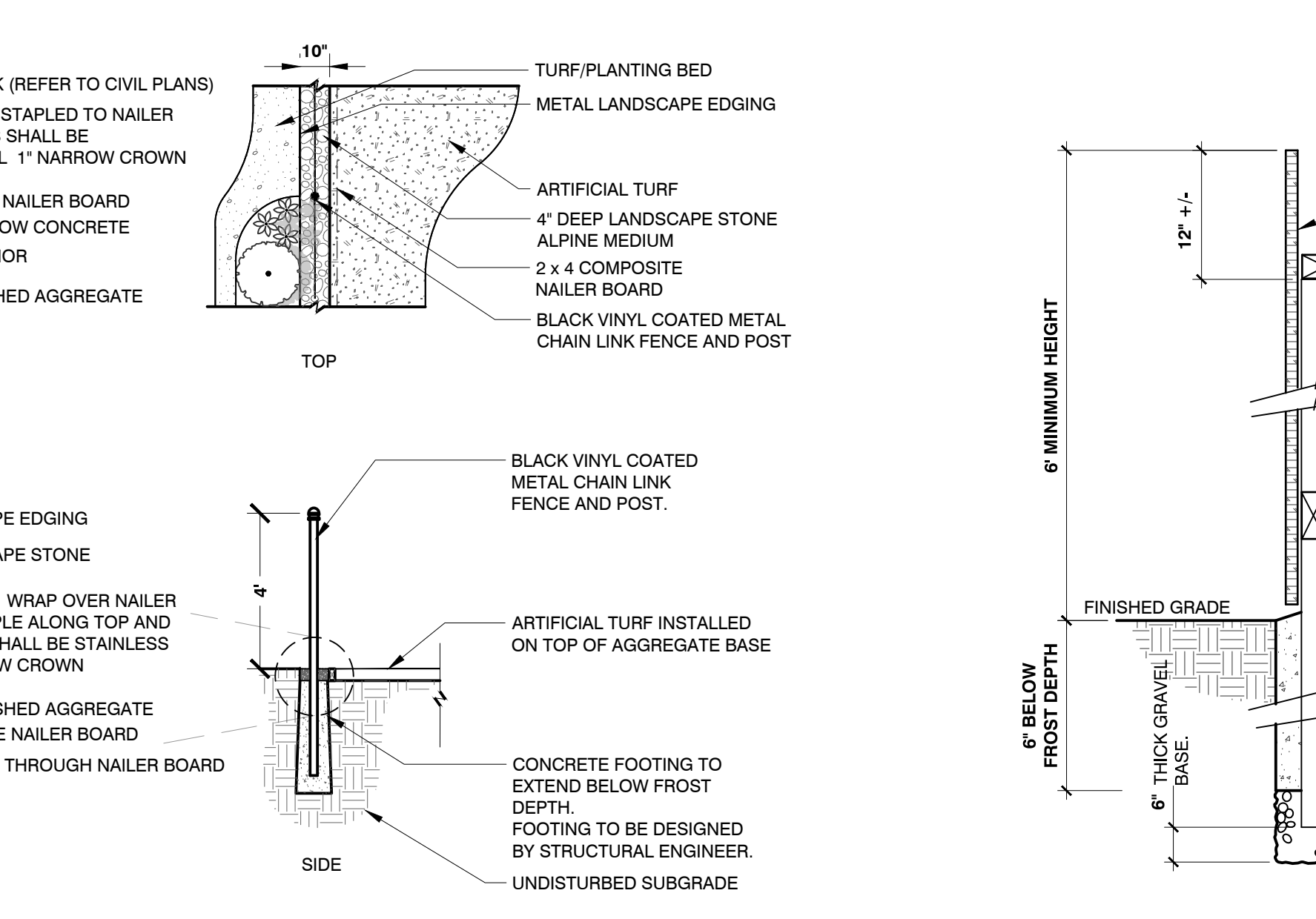

10 6\"/>