

THESE PLANS AND DESIGNS ARE COPYRIGHT PROTECTED AND MAY NOT BE USED IN WHOLE OR IN PART WITHOUT THE WRITTEN CONSENT OF PINNACLE ENGINEERING GROUP, LLC

DESIGNED: ARK
DRAWN: ARK
REVIEWED: ARK

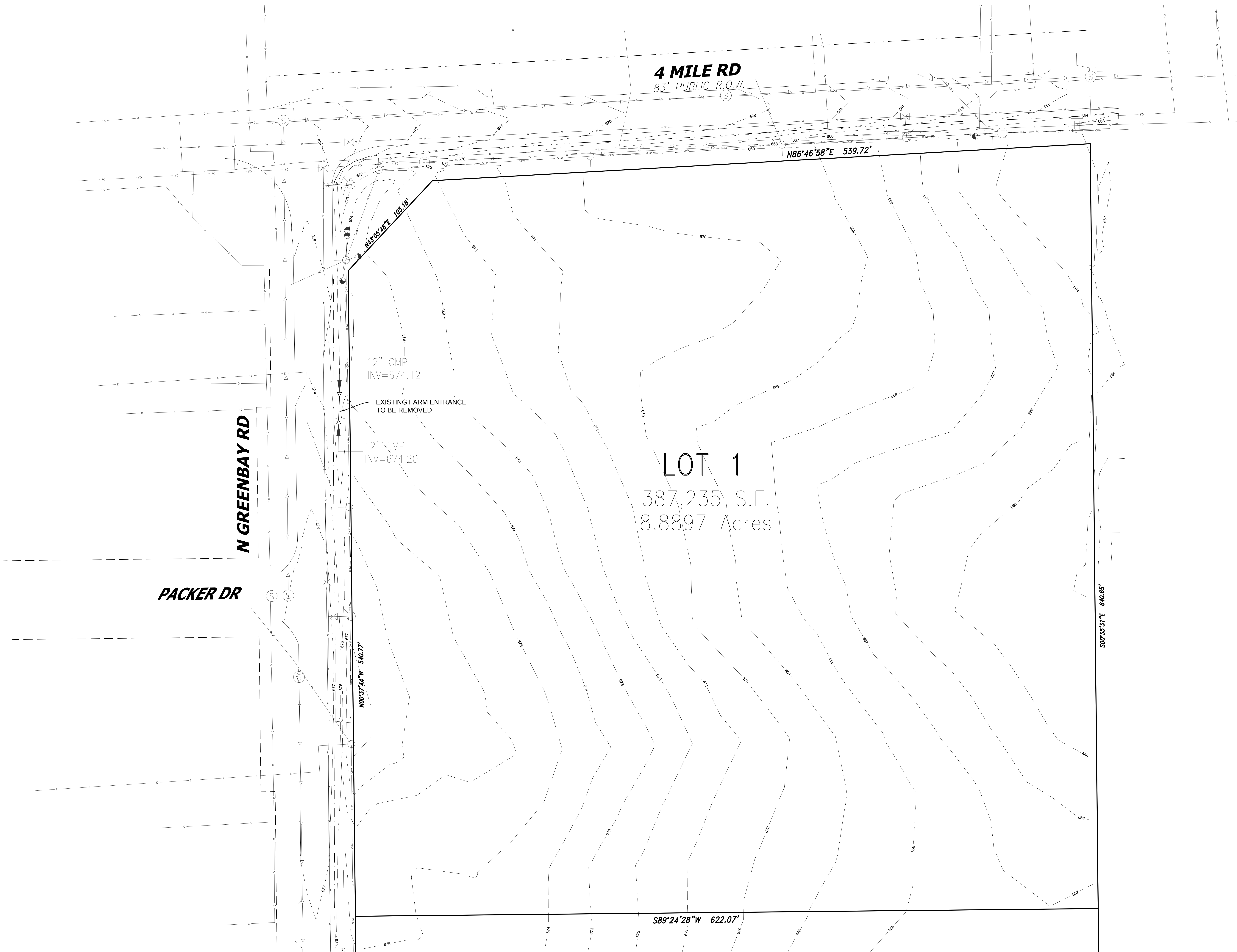

LEGEND OF SYMBOLS	
	SANITARY MANHOLE
	STORM INLET
	CLEANOUT
	CATCH BASIN
	LATERAL
	BASKETBALL HOOP
	SPOT ELEVATION
	AIR CONDITIONING UNIT
	UNKNOWN MANHOLE
	DRIPTER
	HANDICAP STALL
	WELL
	HYDRANT
	WATER VALVE
	WATER SERVICE BOX
	SPRINKLER VALVE
	TRAFFIC SIGNAL
	FLOOD LIGHT
	LIGHT POLE
	FIBER OPTIC VAULT
	FIBER OPTIC MANHOLE
	TELEPHONE PEDESTAL
	TELEPHONE MANHOLE
	TELEPHONE VAULT
	UTILITY POLE
	GUY WIRE
	TRANSFORMER
	ELECTRIC PEDESTAL
	ELECTRIC MANHOLE
	CABLE TV RISER/BOX
	CABLE TV MANHOLE
	GAS VALVE
	GAS METER
	GAS MARKER
	DIRECTIONAL ARROW
	CONIFER TREE
	DECIDUOUS TREE
	BUSH
	WETLAND SYMBOL
	SIGN
	MAIL BOX
	FLAG POLE
	BOLLARD
	CROSS CUT
	IRON PIPE
	IRON REBAR/ROD
	NAIL
	SECTION MONUMENT
	BENCH MARK
UNDERGROUND UTILITY LINES	
	SANITARY SEWER
	STORM SEWER
	WATER MAIN
	FIBER OPTIC
	TELEPHONE
	ELECTRICAL
	OVERHEAD WIRES
	CABLE TELEVISION
	GAS MAIN
	WETLANDS



GRAPHICAL SCALE (FEET)

0 1" = 30' 60'

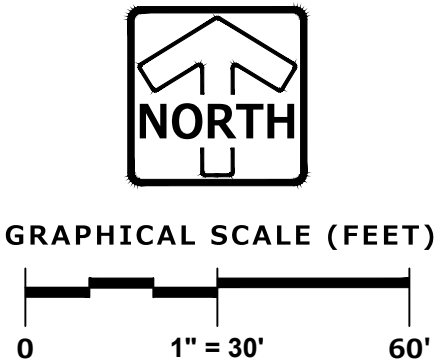
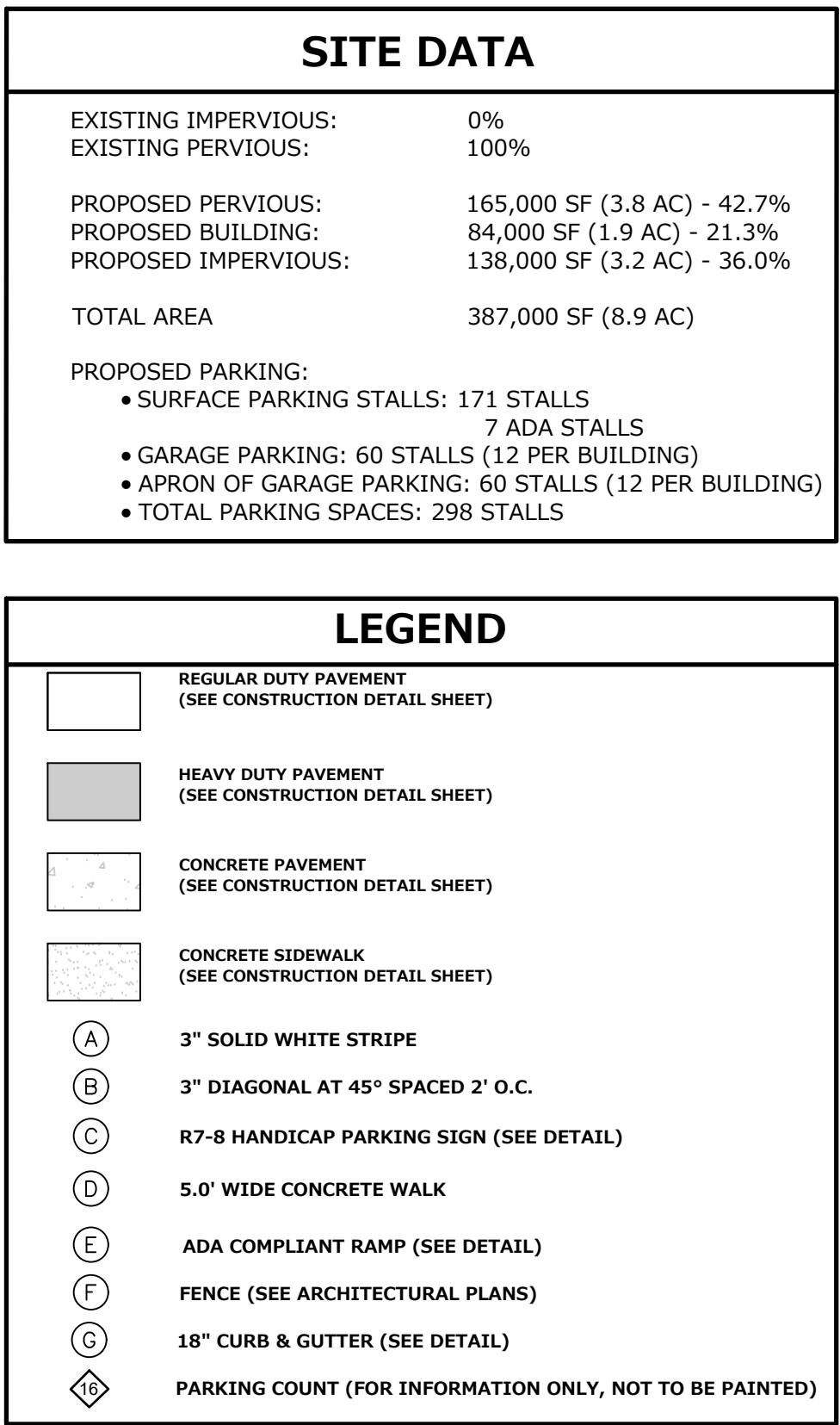

THESE PLANS AND DESIGNS ARE COPYRIGHT PROTECTED AND MAY NOT BE USED IN WHOLE OR IN PART WITHOUT THE WRITTEN CONSENT OF PINNACLE ENGINEERING GROUP, LLC

DESIGNED: AER
CHECKED: AER
REVIEWED: AER
DRAFTED: AER



PINNACLE ENGINEERING GROUP
ENGINEERING | NATURAL RESOURCES | SURVEYING

PLAN | DESIGN | DELIVER
www.pinnacle-engr.com

WISCONSIN OFFICE:
20725 WATERTOWN ROAD, SUITE 100
BROOKFIELD, WI 53006
(262) 754-8888
CHICAGO | MILWAUKEE | NATIONWIDE

Z:\PROJECTS\2024\6046.00-W\CAD\SHEETS\GRADING.DWG

F STREET CALEDONIA
CALEDONIA, WISCONSIN

GRADING & EROSION CONTROL PLAN

REVISIONS	

PROJECT NO. 6046.00
SHEET NO. 8
DATE 12/23/23
SCALE 1"=30'

DESIGNED BY AER
CHECKED BY AER
REVIEWED BY AER
DRAFTED BY AER

SHEET C-3
OF C-15

GRADING & EROSION CONTROL PLAN

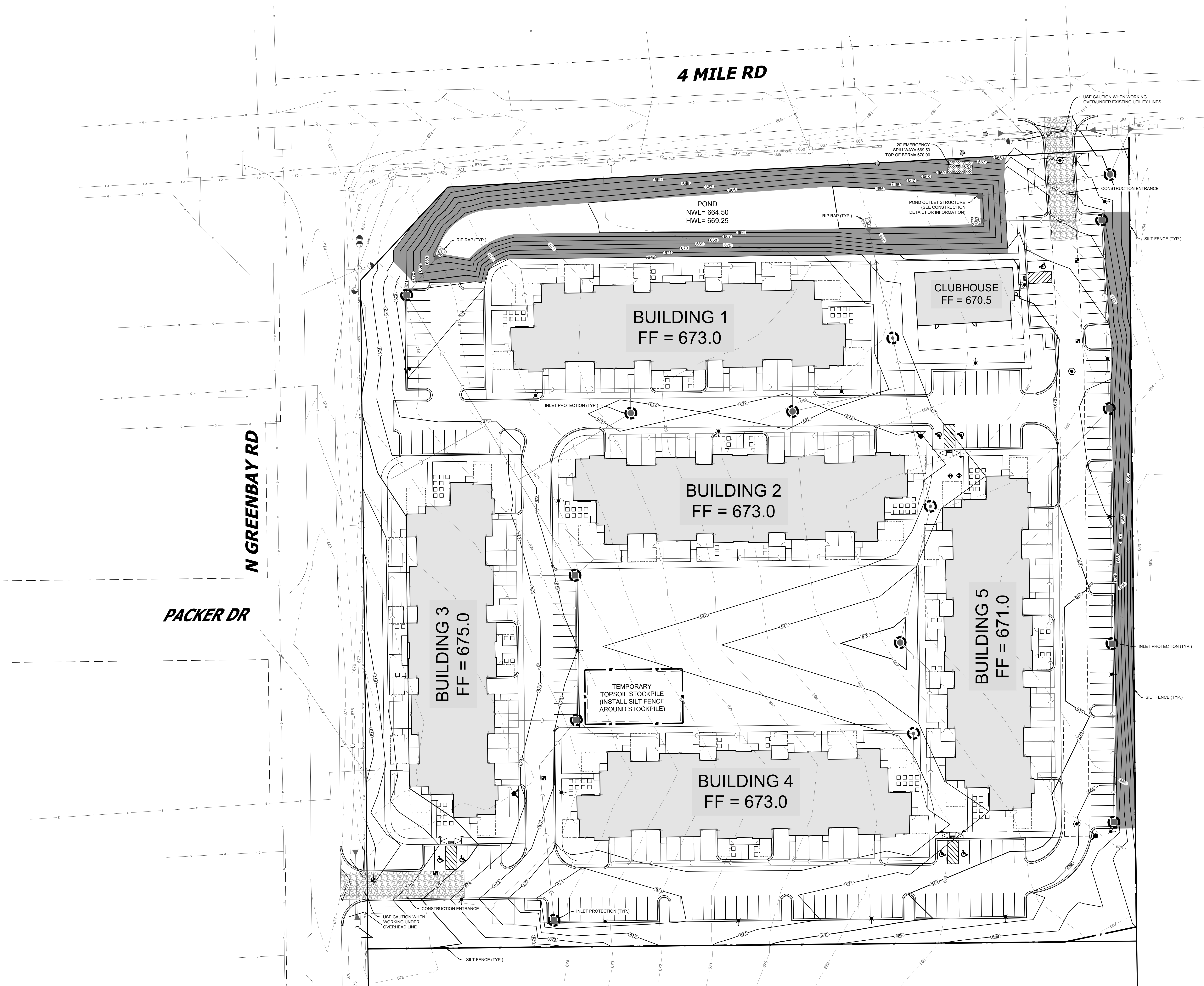

LEGEND

- STORM SEWER MANHOLE
- STORM SEWER CATCH BASIN- ROUND CASTING
- STORM SEWER CATCH BASIN- RECTANGULAR CASTING
- PROPOSED CONCRETE FLARED END SECTION
- PROPOSED CONTOUR
- EXISTING CONTOUR
- SILT FENCE
- OVERFLOW RELIEF ROUTING
- INLET PROTECTION
- CONSTRUCTION ENTRANCE
- EROSION CONTROL BLANKET
 - CHANNEL: NORTH AMERICAN GREEN C125BN OR EQUAL
 - NON-CHANNEL: NORTH AMERICAN GREEN S75 OR EQUAL

CONSTRUCTION SEQUENCE

ALL WORK SHALL BE IN CONFORMANCE WITH THE DNR WPDES PERMIT. SITE SEQUENCING IS ANTICIPATED BASED ON THE BEST INFORMATION AVAILABLE PRIOR TO CONSTRUCTION. DEVIATIONS FROM THE SEQUENCE MAY OCCUR WHEN THERE IS GOOD REASON TO DO SO. ALL CHANGES SHALL BE DOCUMENTED IN WRITING AND REVIEWED/APPROVED BY THE OWNER AND/OR ENGINEER IF NECESSARY.

- INSTALL PERIMETER SILT FENCE, INLET PROTECTION AND TEMPORARY CONSTRUCTION ENTRANCE.
- REMOVAL OF ALL SITE FEATURES THAT INTERFERE WITH NEW DEVELOPMENT INCLUDING ASPHALT, CONCRETE, CURB & GUTTER, FENCES, LIGHT POLES, UTILITIES, TREES, LANDSCAPING & ANY FOUNDATIONS.
- CONSTRUCT STORMWATER POND TO BE USED AS A SEDIMENT BASIN AND TEMPORARY DIVERSION SWALES TO POND. SOME SWALES MAY NOT BE ABLE TO BE CONSTRUCTED UNTIL THE GRADE IS RAISED.
- STRIP AND STOCKPILE TOPSOIL. INSTALL SILT FENCE AROUND PERIMETER OF STOCKPILE. STABILIZE STOCKPILE BY MULCHING, VEGETATIVE COVER, TARP, OR OTHER MEANS IF REMAINING MORE THAN 20 DAYS.
- CONDUCT ROUGH GRADING EFFORTS AND INSTALL CHECK DAMS OR TEMPORARY SEDIMENT BASIN/TRAP AS NEEDED.
- BEGIN BUILDING CONSTRUCTION.
- INSTALL UTILITY PIPING AND STRUCTURES. IMMEDIATELY INSTALL INLET PROTECTION.
- COMPLETE FINAL GRADING, INSTALLATION OF GRAVEL BASE COURSE, PLACEMENT OF CURBS, PAVEMENT, WALKS, ETC.
- PLACE TOPSOIL AND IMMEDIATELY STABILIZE DISTURBED AREAS WITH EROSION CONTROLS.
- EROSION CONTROL MEASURES SHALL BE REMOVED ONLY AFTER SITE CONSTRUCTION IS COMPLETE WITH ALL SOIL SURFACES HAVING AN ESTABLISHED VEGETATIVE COVER.

THESE PLANS AND DESIGNS ARE COPYRIGHT PROTECTED AND MAY NOT BE USED IN WHOLE OR IN PART WITHOUT THE WRITTEN CONSENT OF PINNACLE ENGINEERING GROUP, LLC. DESIGNED: AEM REVISED: AEM DATED: AEM

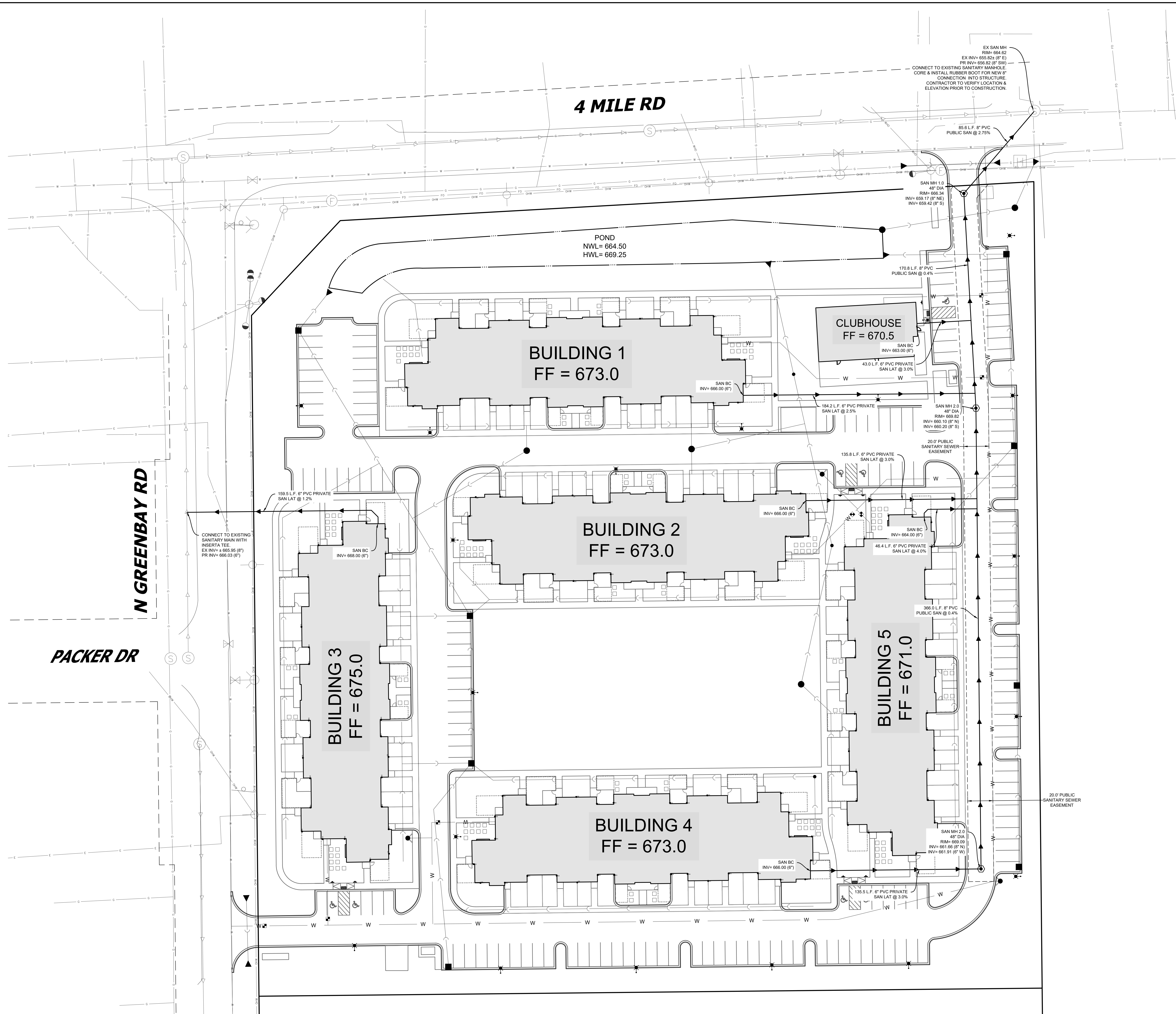

LEGEND

SANITARY SEWER MANHOLE

STORM SEWER MANHOLE

STORM SEWER CATCH BASIN (ROUND CASTING)

STORM SEWER CATCH BASIN (RECTANGULAR CASTING)

PRECAST CONCRETE FLARED END SECTION

DOWNSPOUT

CLEANOUT

VALVE BOX

FIRE HYDRANT

SANITARY SEWER

STORM SEWER

DRAIN TILE

TELEPHONE LINE

WATER MAIN

FIRE PROTECTION

UTILITY CROSSING

ELECTRICAL CABLE

GAS MAIN

OVERHEAD WIRES

LIGHTING

ELECTRICAL TRANSFORMER OR PEDESTAL

POWER POLE

POWER POLE WITH LIGHTS

STREET SIGN

SANITARY SEWER & LATERAL NOTES:

- TRACER WIRE IS REQUIRED FOR SANITARY SEWER & SANITARY LATERALS.
- ALL SANITARY SEWER LATERALS SHALL BE INSTALLED PER CALEDONIA UTILITY DISTRICT SPECIFICATIONS.

NORTH

GRAPHICAL SCALE (FEET)

0

1" = 30'

60'

PINNACLE ENGINEERING GROUP
ENGINEERING | NATURAL RESOURCES | SURVEYING

PLAN | DESIGN | DELIVER
www.pinnacle-engr.com

WISCONSIN OFFICE:
20725 WATERTOWN ROAD, SUITE 100
BROOKFIELD, WI 53186
(262) 754-8888
CHICAGO | MILWAUKEE | NATIONWIDE

F STREET CALEDONIA
CALEDONIA, WISCONSIN

SANITARY SEWER PLAN

REVISIONS		DATE	BY	APP

PROJECT No. 6046.00

AWK

START DATE 12/23/23

SCALE 1"=30'

SHEET

C-4

OF

C-15

THESE PLANS AND DESIGNS ARE COPYRIGHT PROTECTED AND MAY NOT BE USED IN WHOLE OR IN PART WITHOUT THE WRITTEN CONSENT OF PINNACLE ENGINEERING GROUP, LLC

DESIGNED: AAK
CHECKED: AAK
REVIEWED: AAK
DRAFTED: AAK

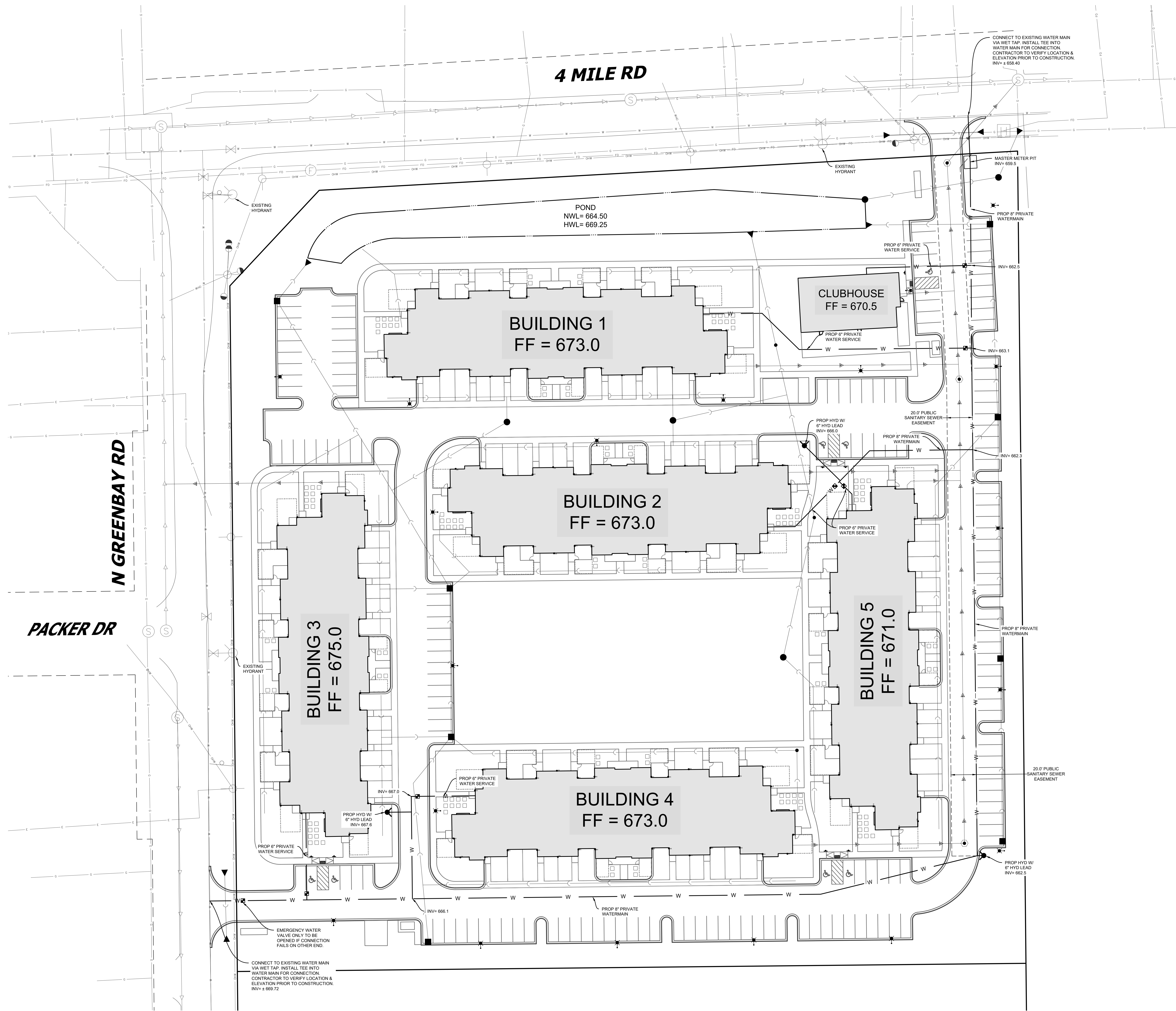

LEGEND	
	SANITARY SEWER MANHOLE
	STORM SEWER MANHOLE
	ACCESS PORT
	STORM SEWER CATCH BASIN (ROUND CASTING)
	STORM SEWER CATCH BASIN (RECTANGULAR CASTING)
	PRECAST CONCRETE FLARED END SECTION
	DOWNSPOUT
	CLEANOUT
	VALVE BOX
	FIRE HYDRANT
	SANITARY SEWER
	STORM SEWER
	DRAIN TILE
	TELEPHONE LINE
	WATER MAIN
	FIRE PROTECTION
	UTILITY CROSSING
	ELECTRICAL CABLE
	GAS MAIN
	OVERHEAD WIRES
	LIGHTING
	ELECTRICAL TRANSFORMER OR PEDESTAL
	POWER POLE
	POWER POLE WITH LIGHTS
	STREET SIGN

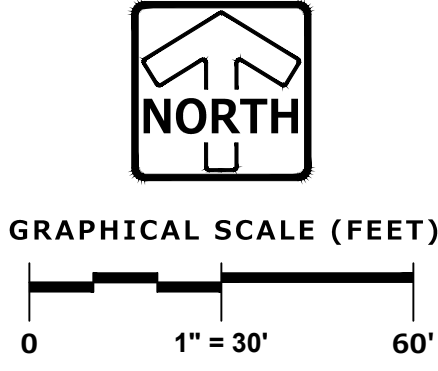

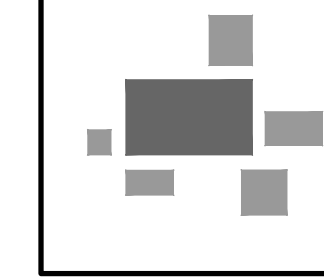

PINNACLE ENGINEERING GROUP
ENGINEERING | NATURAL RESOURCES | SURVEYING

PLAN | DESIGN | DELIVER
www.pinnacle-engr.com

WISCONSIN OFFICE:
20725 WATERTOWN ROAD, SUITE 100
BROOKFIELD, WI 53186
(262) 754-8888
CHICAGO | MILWAUKEE | NATIONWIDE

F STREET CALEDONIA
CALEDONIA, WISCONSIN

WATERMAIN PLAN

REVISIONS		SHEET C-5 of C-15

THESE PLANS AND DESIGNS ARE COPYRIGHT PROTECTED AND MAY NOT BE USED IN WHOLE OR IN PART WITHOUT THE WRITTEN CONSENT OF PINNACLE ENGINEERING GROUP, LLC. DESIGNED: AEM REVISED: AEM DATED: AEM

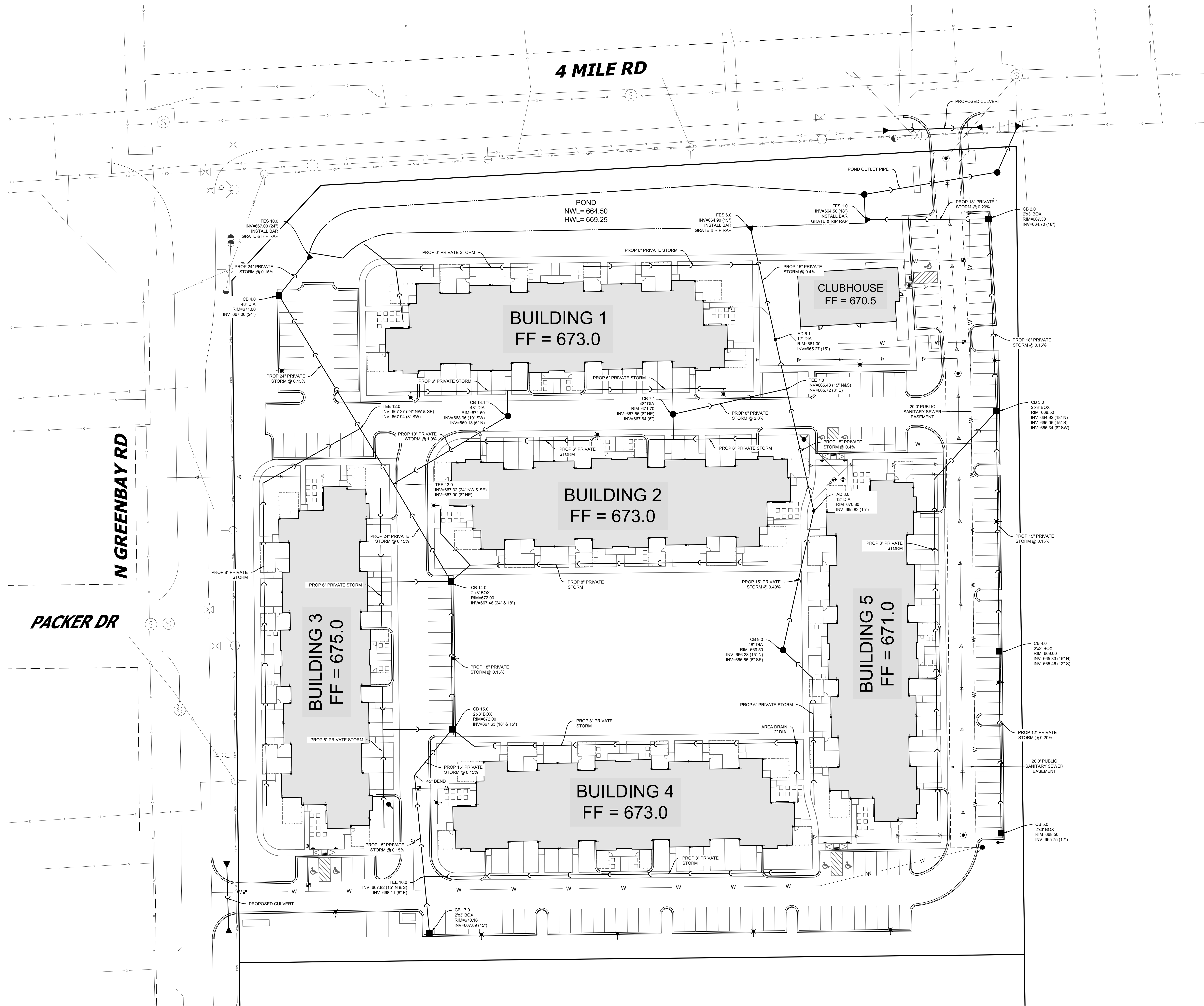

LEGEND

SANITARY SEWER MANHOLE

STORM SEWER MANHOLE

STORM SEWER CATCH BASIN (ROUND CASTING)

ACCESS PORT

STORM SEWER CATCH BASIN (RECTANGULAR CASTING)

PRECAST CONCRETE FLARED END SECTION

DOWNSPOUT

CLEANOUT

VALVE BOX

FIRE HYDRANT

SANITARY SEWER

STORM SEWER

DRAIN TILE

TELEPHONE LINE

WATER MAIN

FIRE PROTECTION

UTILITY CROSSING

ELECTRICAL CABLE

GAS MAIN

OVERHEAD WIRES

LIGHTING

ELECTRICAL TRANSFORMER OR PEDESTAL

POWER POLE

POWER POLE WITH LIGHTS

STREET SIGN

STORM SEWER NOTES:

- ALL RIM ELEVATIONS ON CURB CATCH BASINS ARE GIVEN AT THE FLOWLINE.

- BUILDING DOWNSPOUTS SHALL CONNECT TO STORM SEWER. SEE ARCHITECTURAL PLANS FOR DOWNSPOUT LOCATIONS.

PINNACLE ENGINEERING GROUP
ENGINEERING | NATURAL RESOURCES | SURVEYING

PLAN | DESIGN | DELIVER
www.pinnacle-engr.com

WISCONSIN OFFICE:
20725 WATERTOWN ROAD, SUITE 100
BROOKFIELD, WI 53186
(262) 754-8888

CHICAGO | MILWAUKEE | WATKINSON

F STREET CALEDONIA

CALEDONIA, WISCONSIN

STORM SEWER PLAN

REVISIONS

PREC. DB No. 6046.00
PREC. PM. AEM
START DATE 12/23/23
SCALE 1"=30'

SHEET
C-6
of
C-15

DESIGNED: AEM
DRAFTED: AEM
REVIEWED: AEM
THESE PLANS AND DESIGNS ARE COPYRIGHT PROTECTED AND MAY NOT BE USED IN WHOLE OR IN PART WITHOUT THE WRITTEN CONSENT OF PINNACLE ENGINEERING GROUP, LLC



PINNACLE ENGINEERING GROUP
ENGINEERING | NATURAL RESOURCES | SURVEYING

PLAN | DESIGN | DELIVER
www.pinnacle-engr.com

WISCONSIN OFFICE:
20725 WATERTOWN ROAD, SUITE 100
BROOKFIELD, WI 53186
(262) 754-8888
CHICAGO | MILWAUKEE | NATIONWIDE

Z:\PROJECTS\2024\6046.00-W\CAD\SHEETS\PAVING PLAN.DWG

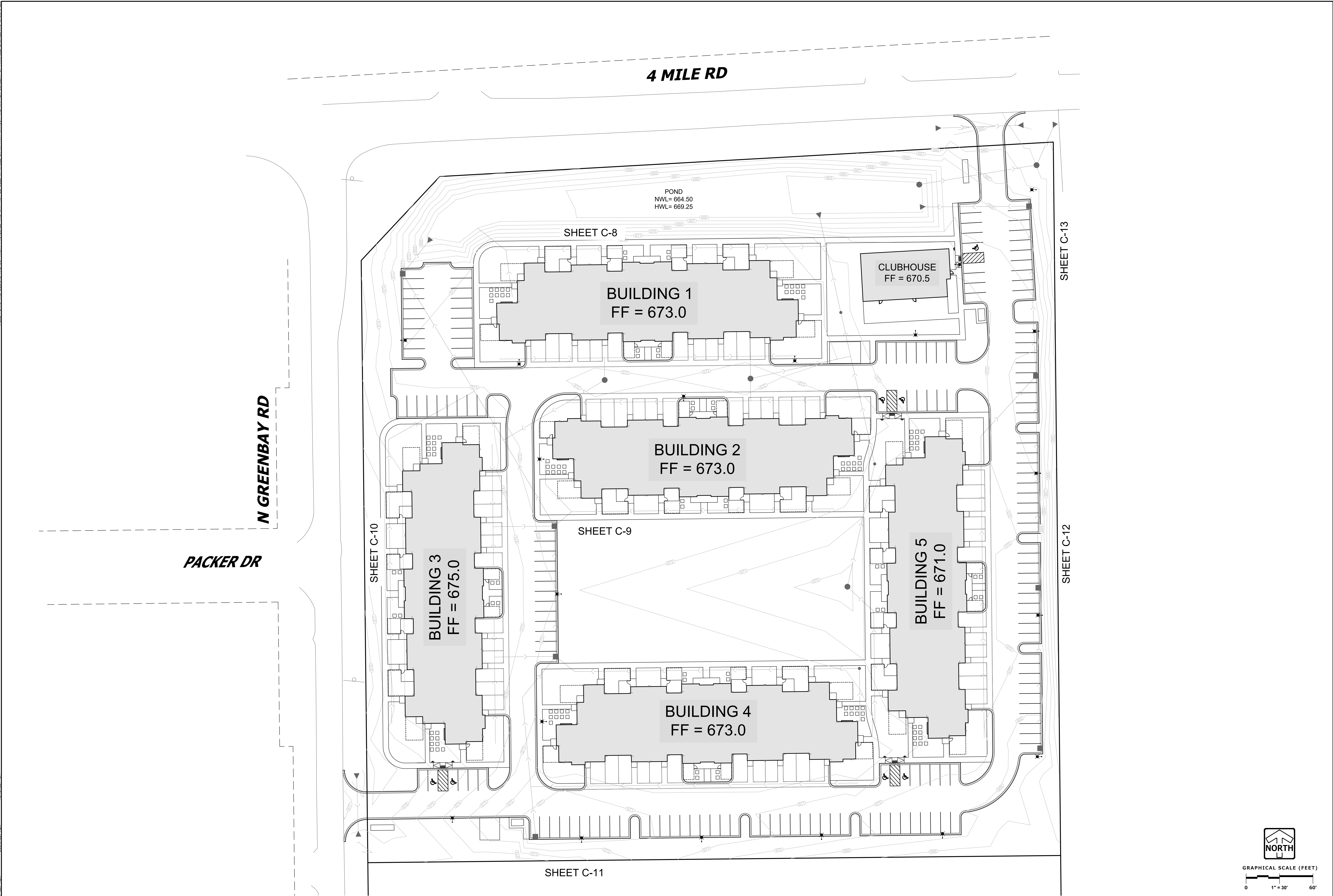

F STREET CALEDONIA
CALEDONIA, WISCONSIN

PAVING PLAN OVERVIEW

REVISIONS

REC'D BY NO. 6046.00 REC'D BY AEM START DATE 12/23/23 SCALE 1"=30'	SHEET C-7 of C-15
---	----------------------------

PAVING PLAN OVERVIEW

www.pinnacle-engr.com

THESE PLANS AND DESIGNS ARE COPYRIGHT PROTECTED AND MAY NOT BE USED IN WHOLE OR IN PART WITHOUT THE WRITTEN CONSENT OF PINNACLE ENGINEERING GROUP, LLC

DESIGNED: AAK

DRAWN: AAK

REVIEWED: AAK

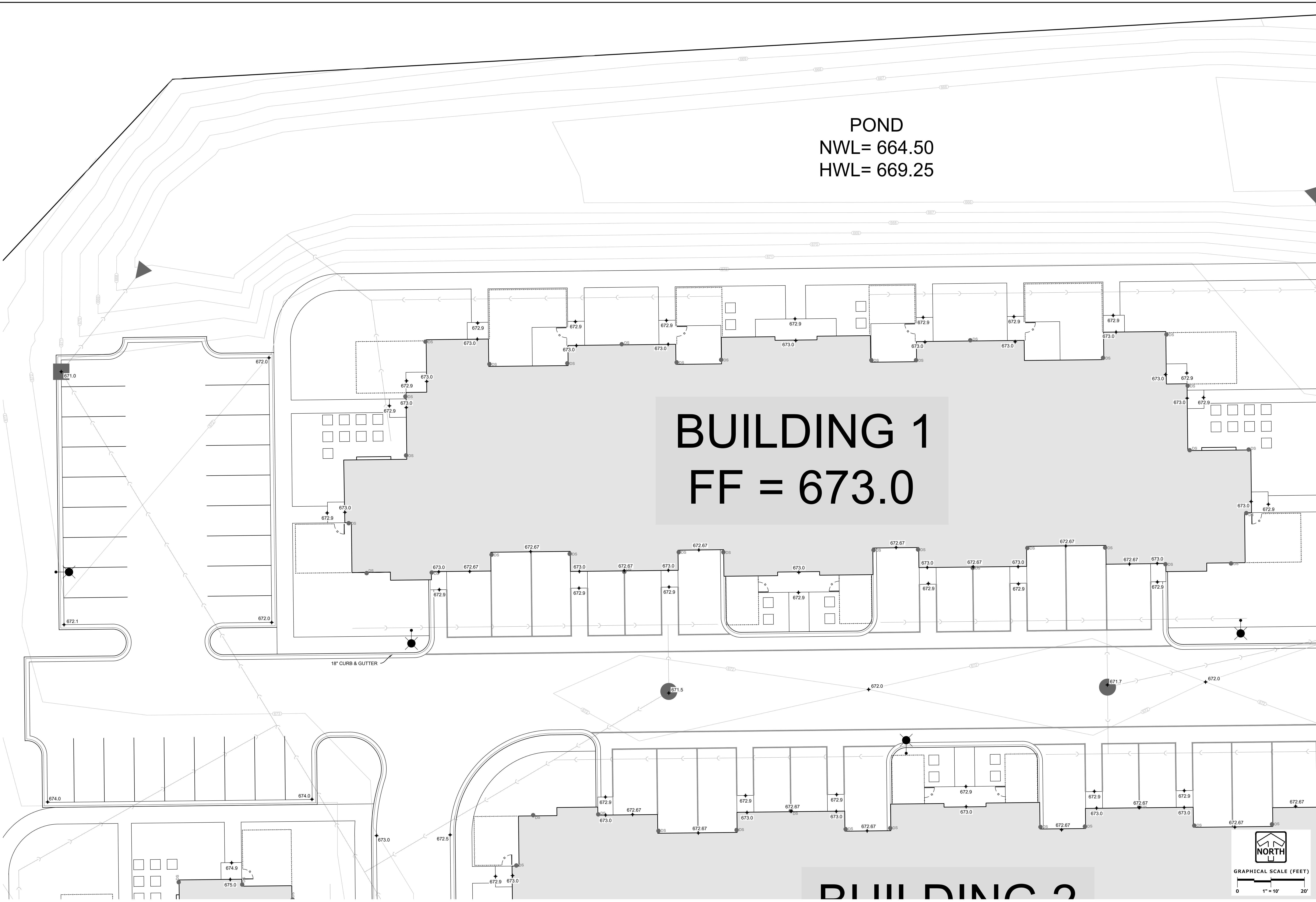

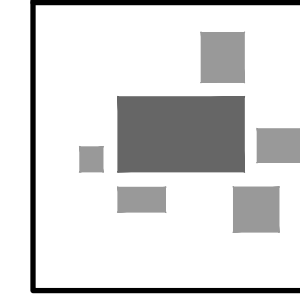

PINNACLE ENGINEERING GROUP
ENGINEERING | NATURAL RESOURCES | SURVEYING

PLAN | DESIGN | DELIVER
www.pinnacle-engr.com

WISCONSIN OFFICE:
20725 WATERTOWN ROAD, SUITE 100
BROOKFIELD, WI 53186
(262) 754-8888
CHICAGO | MILWAUKEE | NATIONWIDE

F STREET CALEDONIA
CALEDONIA, WISCONSIN

PAVING PLAN

REVISIONS

PROJECT NO. 6046.00
SHEET NO. 1
START DATE 12/23/23
SCALE 1" = 10'

SHEET
C-8
OF
C-15

PAVING PLAN

www.pinnacle-engr.com

THESE PLANS AND DESIGNS ARE COPYRIGHT PROTECTED AND MAY NOT BE USED IN WHOLE OR IN PART WITHOUT THE WRITTEN CONSENT OF PINNACLE ENGINEERING GROUP, LLC
DESIGNED: AER
REVIEWED: AER

BUILDING 1
FF = 673.0

BUILDING 2
FF = 673.0

BUILDING 5
FF = 673.0



GRAPHICAL SCALE (FEET)
0 1" = 10' 20'

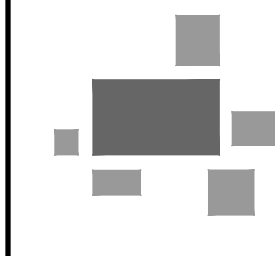

PLAN | DESIGN | DELIVER
www.pinnacle-engr.com

WISCONSIN OFFICE:
20725 WATERTOWN ROAD, SUITE 100
BROOKFIELD, WI 53005
(262) 754-8888
ENGINEERING | NATURAL RESOURCES | SURVEYING CHICAGO | MILWAUKEE | NATIONWIDE

F STREET CALEDONIA
CALEDONIA, WISCONSIN

PAVING PLAN

REVISIONS

PROJECT NO.	6046.00
PROJECT NAME	AEK
START DATE	12/23/23
SCALE	1" = 10'

SHEET	C-9
OF	8
SHEET	C-15

PAVING PLAN

www.pinnacle-engr.com

THESE PLANS AND DESIGNS ARE COPYRIGHT PROTECTED AND MAY NOT BE USED IN WHOLE OR IN PART WITHOUT THE WRITTEN CONSENT OF PINNACLE ENGINEERING GROUP, LLC

DESIGNED: AEM
DRAWN: AEM
REVIEWED: AEM

NORTH GREENBAY ROAD

BUILDING 3
FF = 675.0

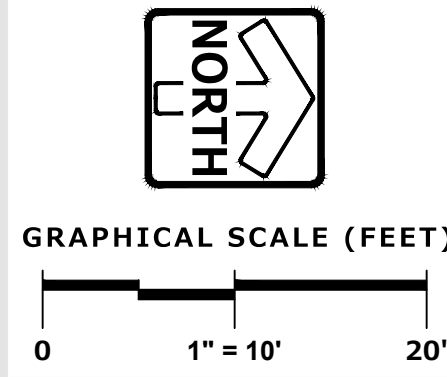



PINNACLE ENGINEERING GROUP
ENGINEERING | NATURAL RESOURCES | SURVEYING

PLAN | DESIGN | DELIVER
www.pinnacle-engr.com

WISCONSIN OFFICE:
20725 WATERTOWN ROAD, SUITE 100
BROOKFIELD, WI 53186
(262) 754-8888
CHICAGO | MILWAUKEE | NATIONWIDE

F STREET CALEDONIA
CALEDONIA, WISCONSIN

PAVING PLAN

REVISIONS	

PROJECT NO. 6046.00
PROJECT NAME AEM
START DATE 12/23/23
SCALE 1" = 10'

SHEET C-10
OF C-15

PAVING PLAN

www.pinnacle-engr.com

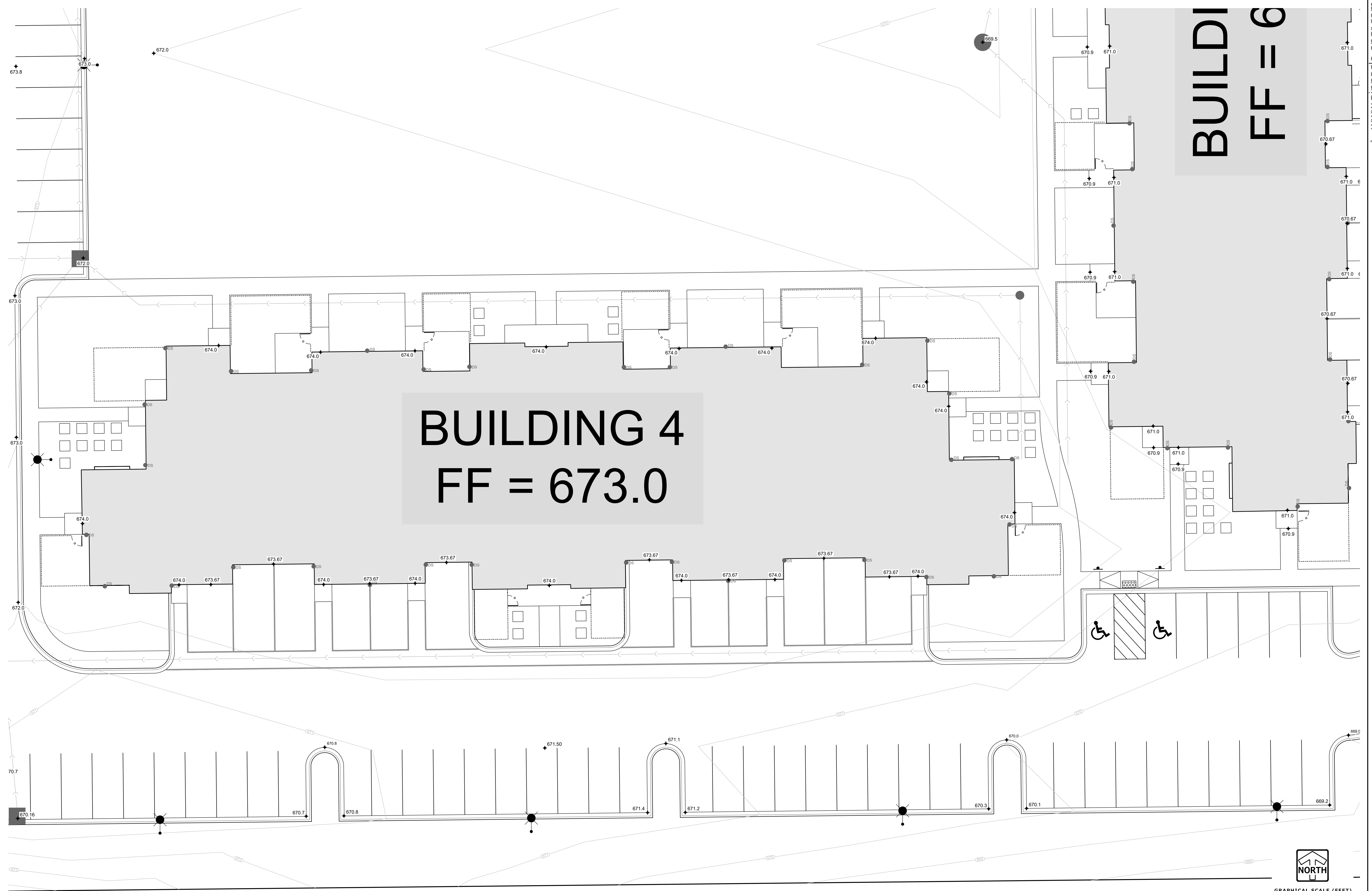

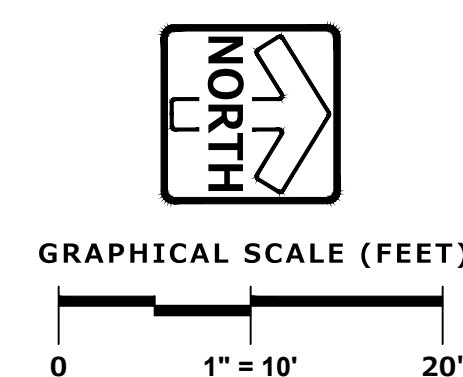

Z:\PROJECTS\2024\6046.00-WI\CAD\SHEETS\PAVING PLAN.DWG

PAVING PLAN

REVISIONS					
_____	_____	_____	_____	_____	_____
_____	_____	_____	_____	_____	_____
_____	_____	_____	_____	_____	_____

PEG JOB No.	6046.00
PEG PM	AEK

SHEET
C-12
OF
C-15

DESIGNED: A/E/K
DRAWN: A/E/K
REVIEWED: A/E/K
THESE PLANS AND DESIGNS ARE COPYRIGHT PROTECTED AND MAY NOT BE USED IN WHOLE OR IN PART WITHOUT THE WRITTEN CONSENT OF PINNACLE ENGINEERING GROUP, LLC



PINNACLE ENGINEERING GROUP
ENGINEERING | NATURAL RESOURCES | SURVEYING

PLAN | DESIGN | DELIVER
www.pinnacle-engr.com

WISCONSIN OFFICE:
20725 WATERTOWN ROAD, SUITE 100
BROOKFIELD, WI 53186
(262) 754-8888
CHICAGO | MILWAUKEE | NATIONWIDE

F STREET CALEDONIA

CALEDONIA, WISCONSIN

PAVING PLAN

REVISIONS	

PREC. DB. No. 6046.00
PREC. PM. A/E/K
START DATE 12/23/25
SCALE 1" = 10'

SHEET

C-13

8

C-15

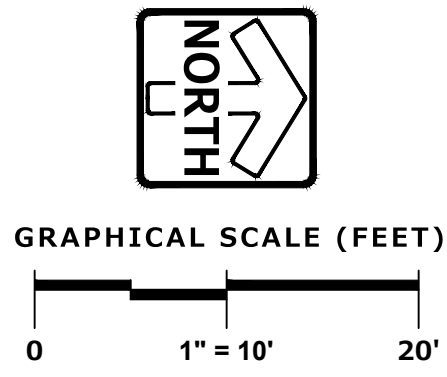

THESE PLANS AND DESIGNS ARE COPYRIGHT PROTECTED AND MAY NOT BE USED IN WHOLE OR IN PART WITHOUT THE WRITTEN CONSENT OF PINNACLE ENGINEERING GROUP, LLC. DRAWN: AAK DESIGNED: AAK REVIEWED: AAK

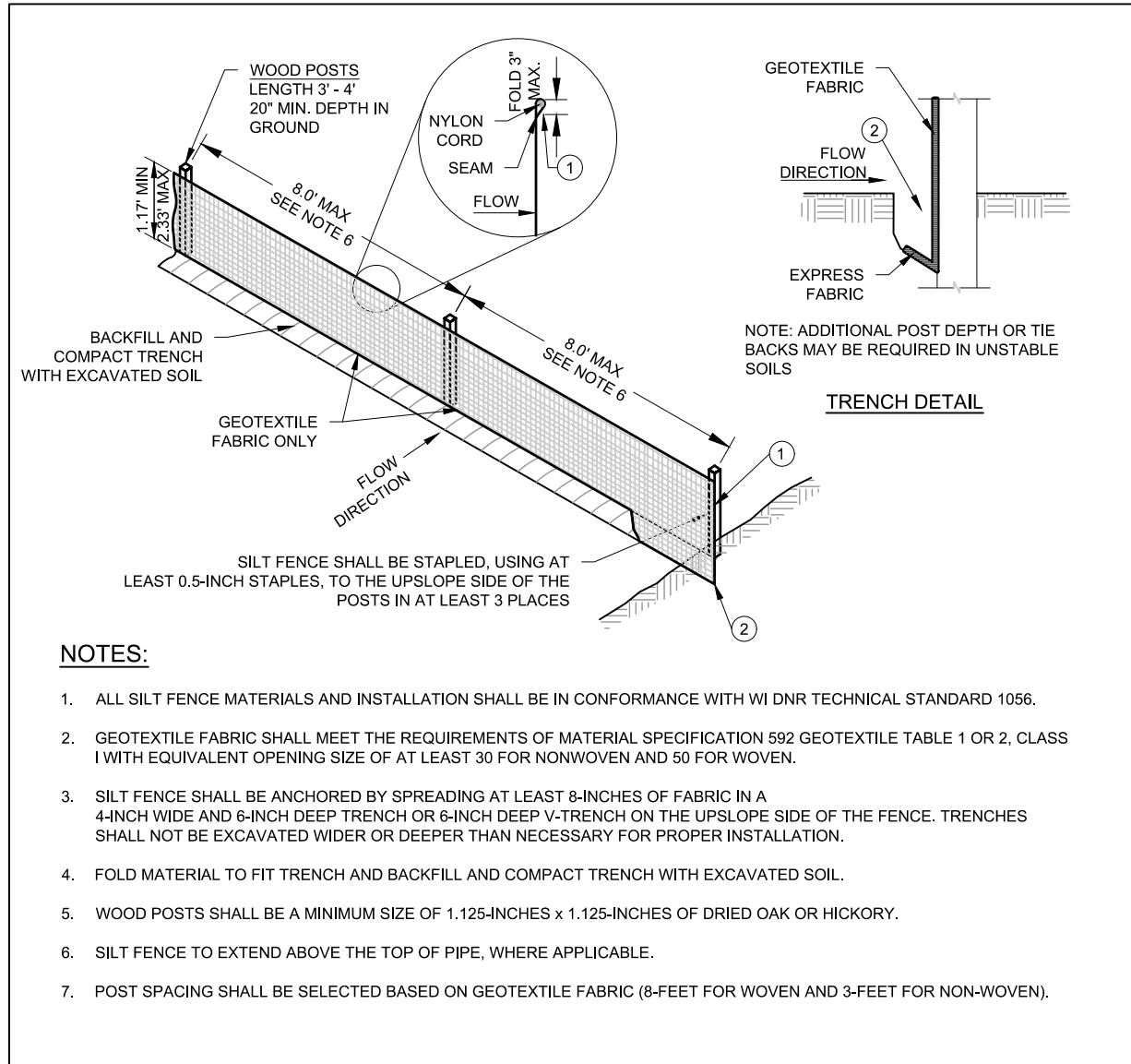

SILT FENCE

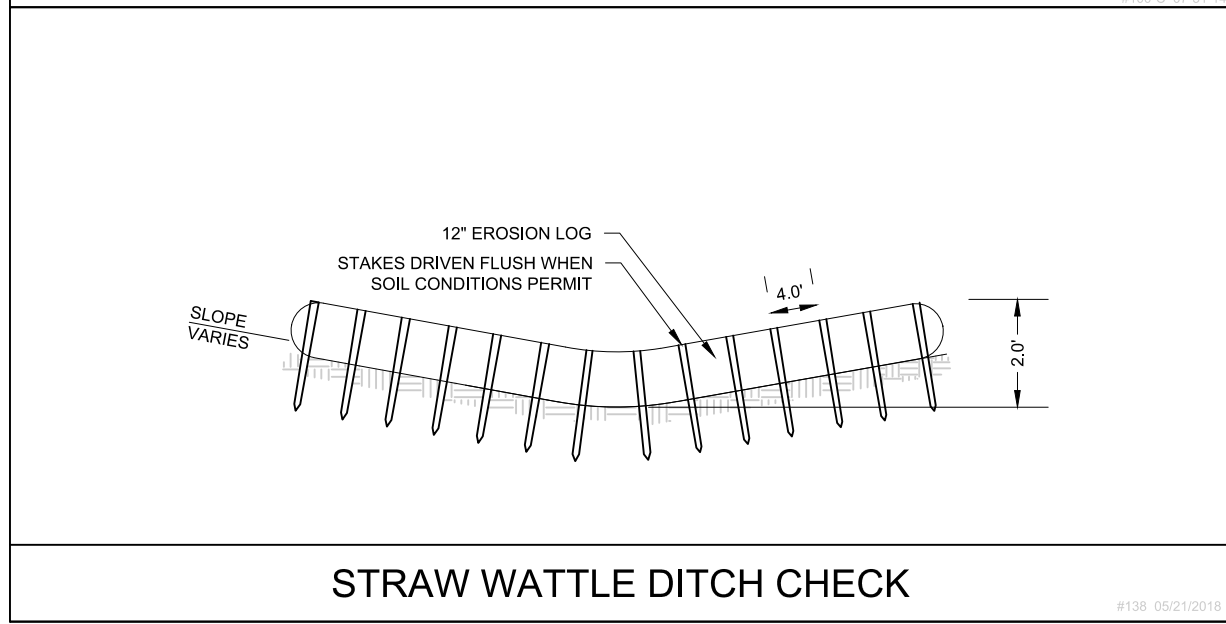

STRAW WATTLE DITCH CHECK

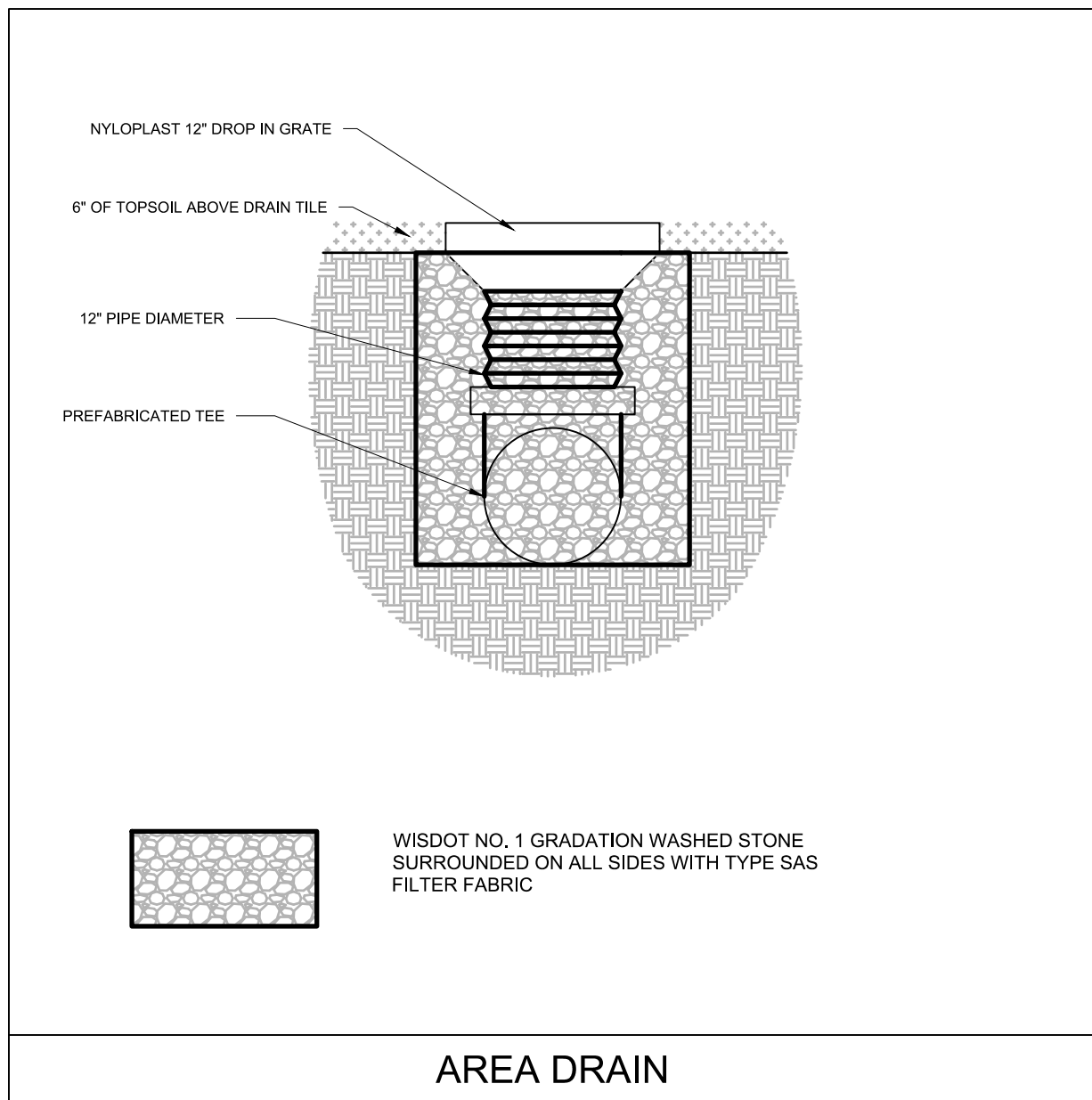

AREA DRAIN

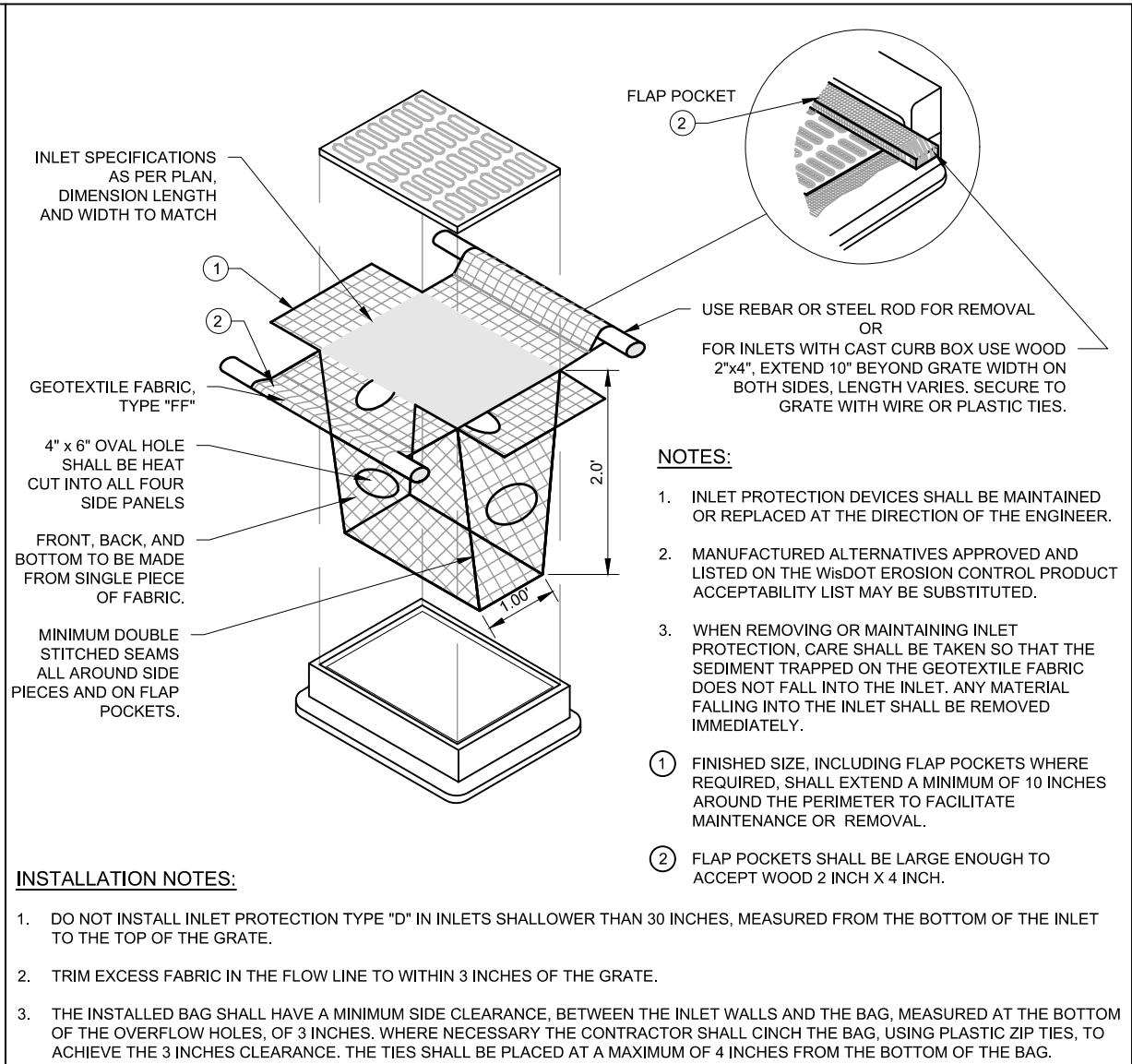

INLET PROTECTION

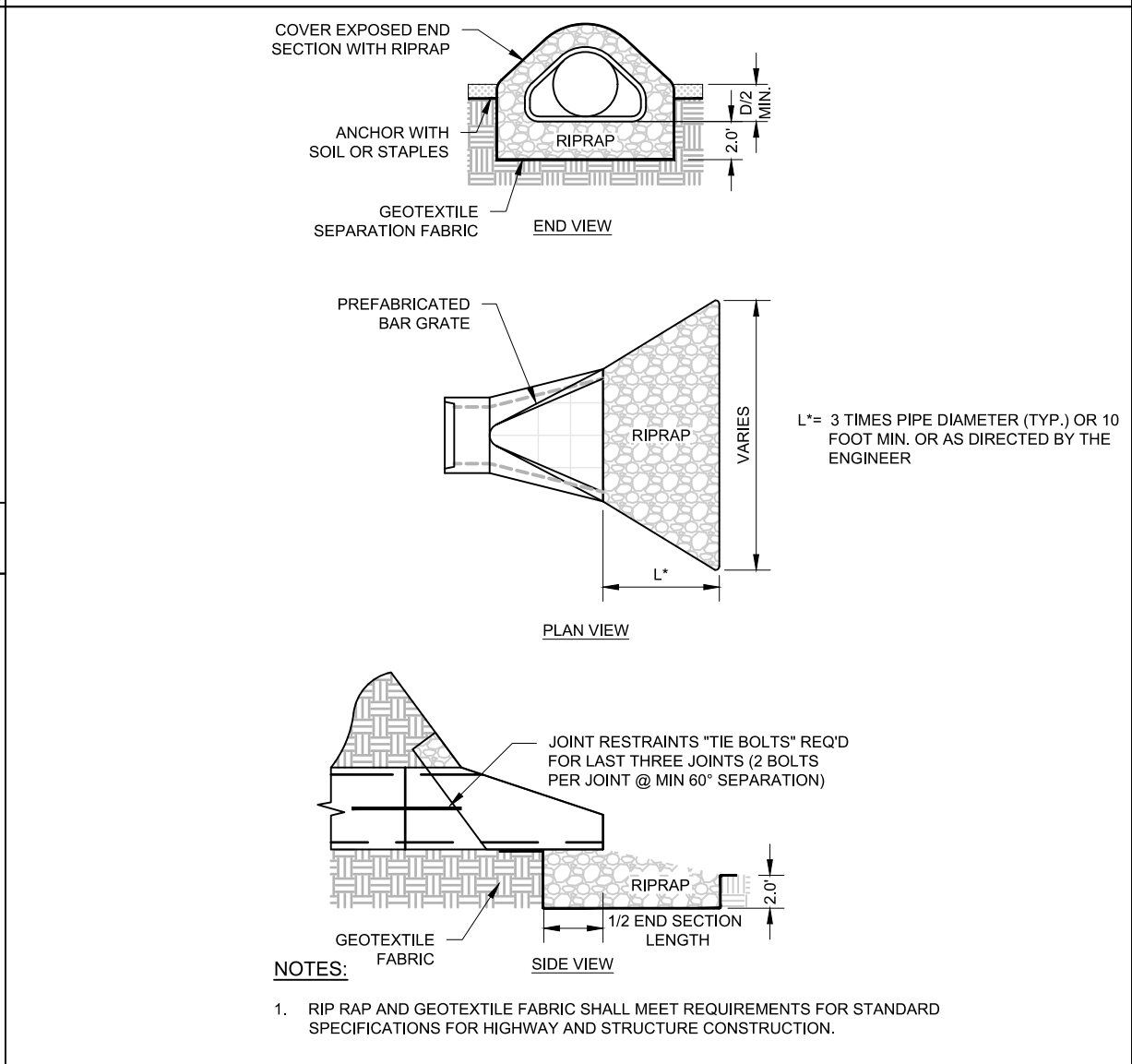

RIP RAP AT END SECTIONS

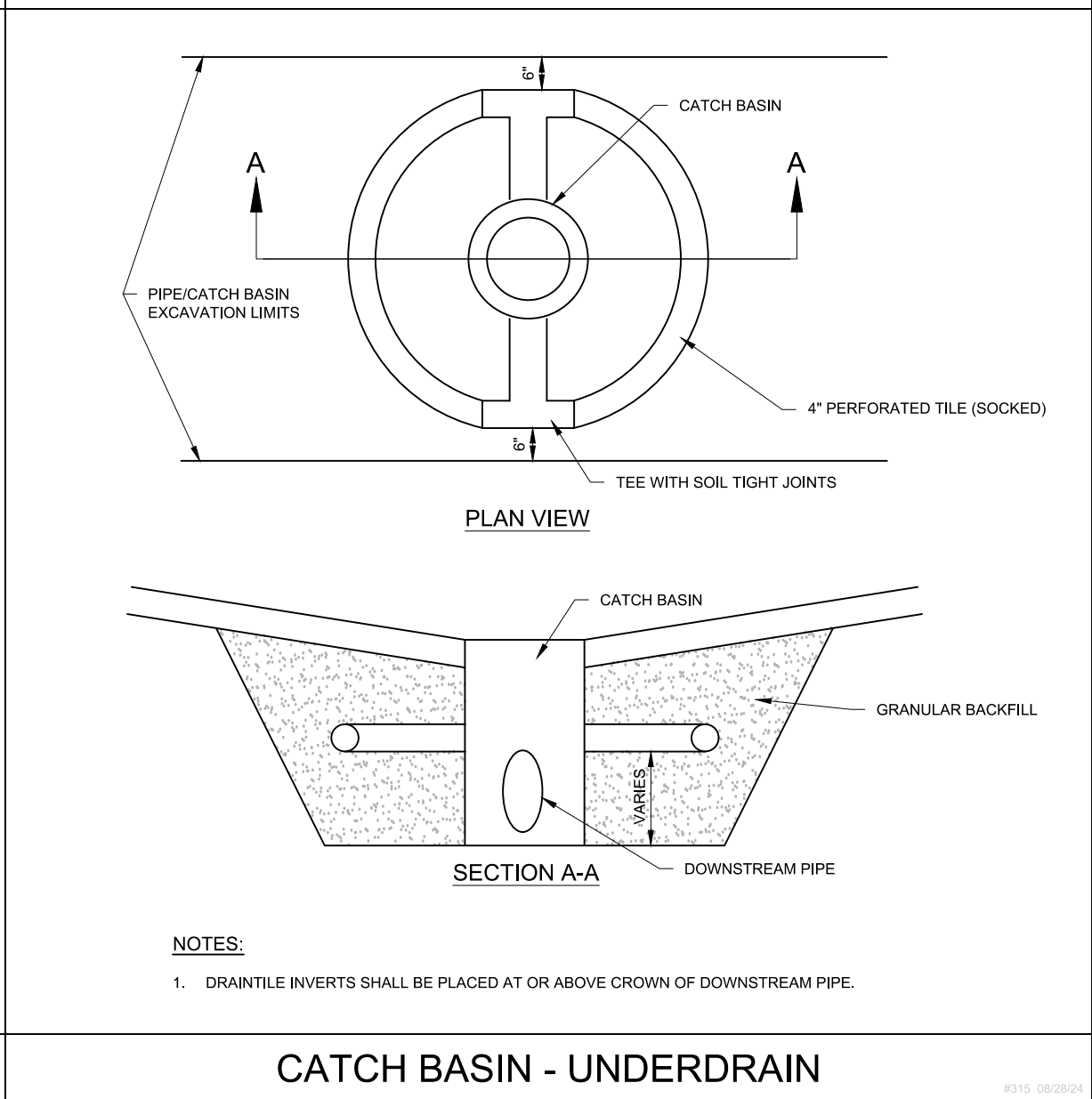

CATCH BASIN - UNDERDRAIN

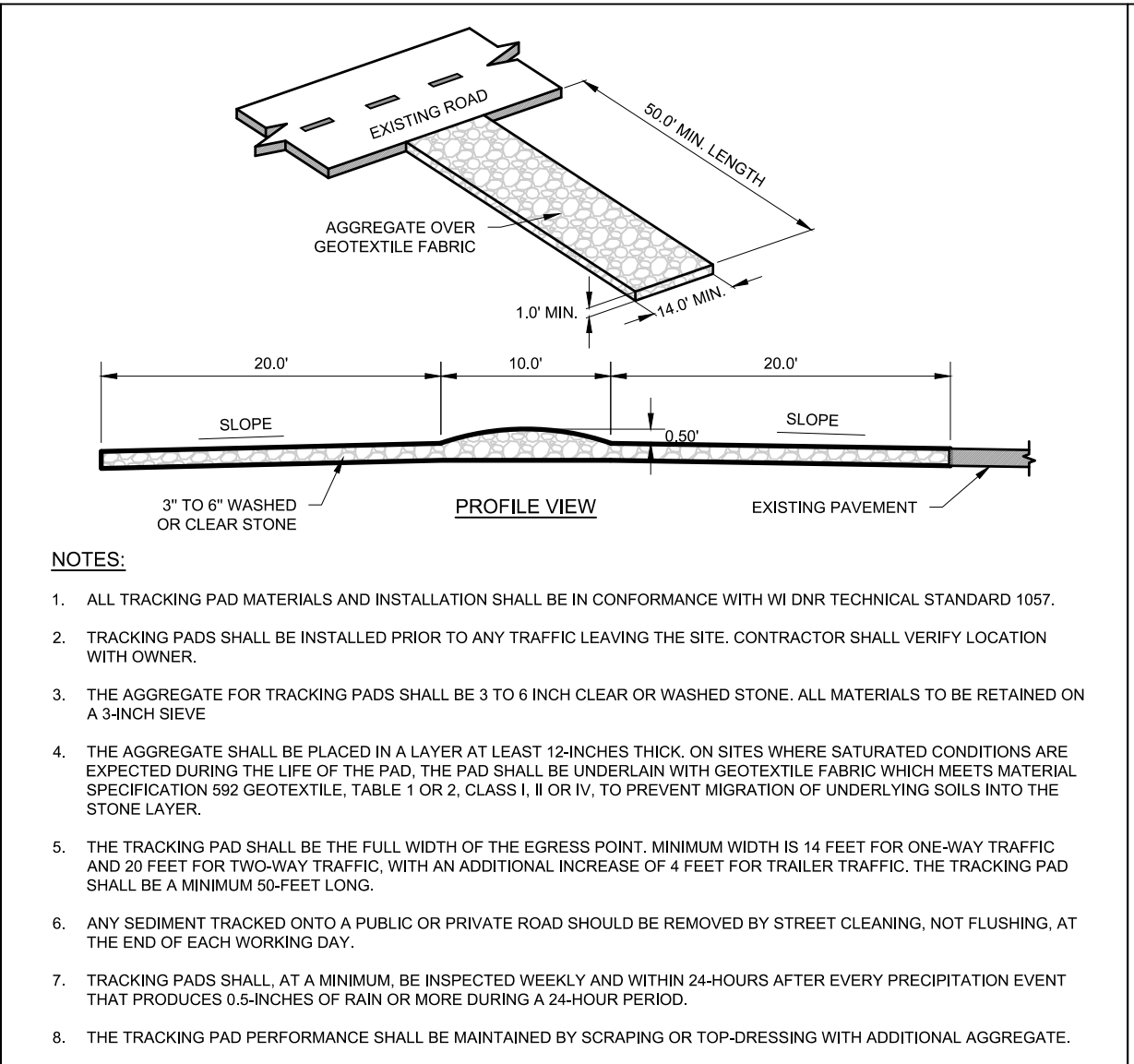

CONSTRUCTION ENTRANCE

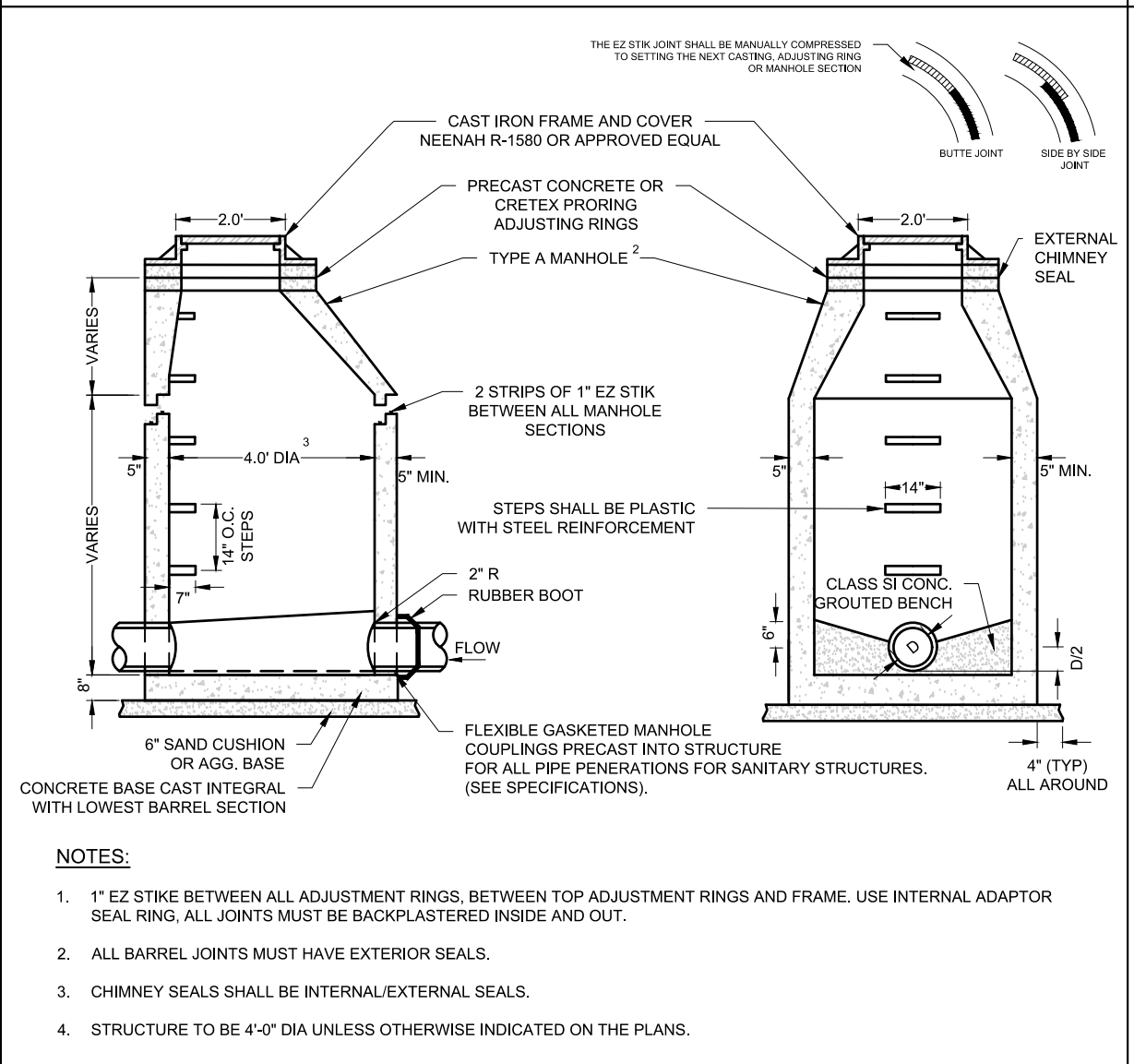

SANITARY MANHOLE

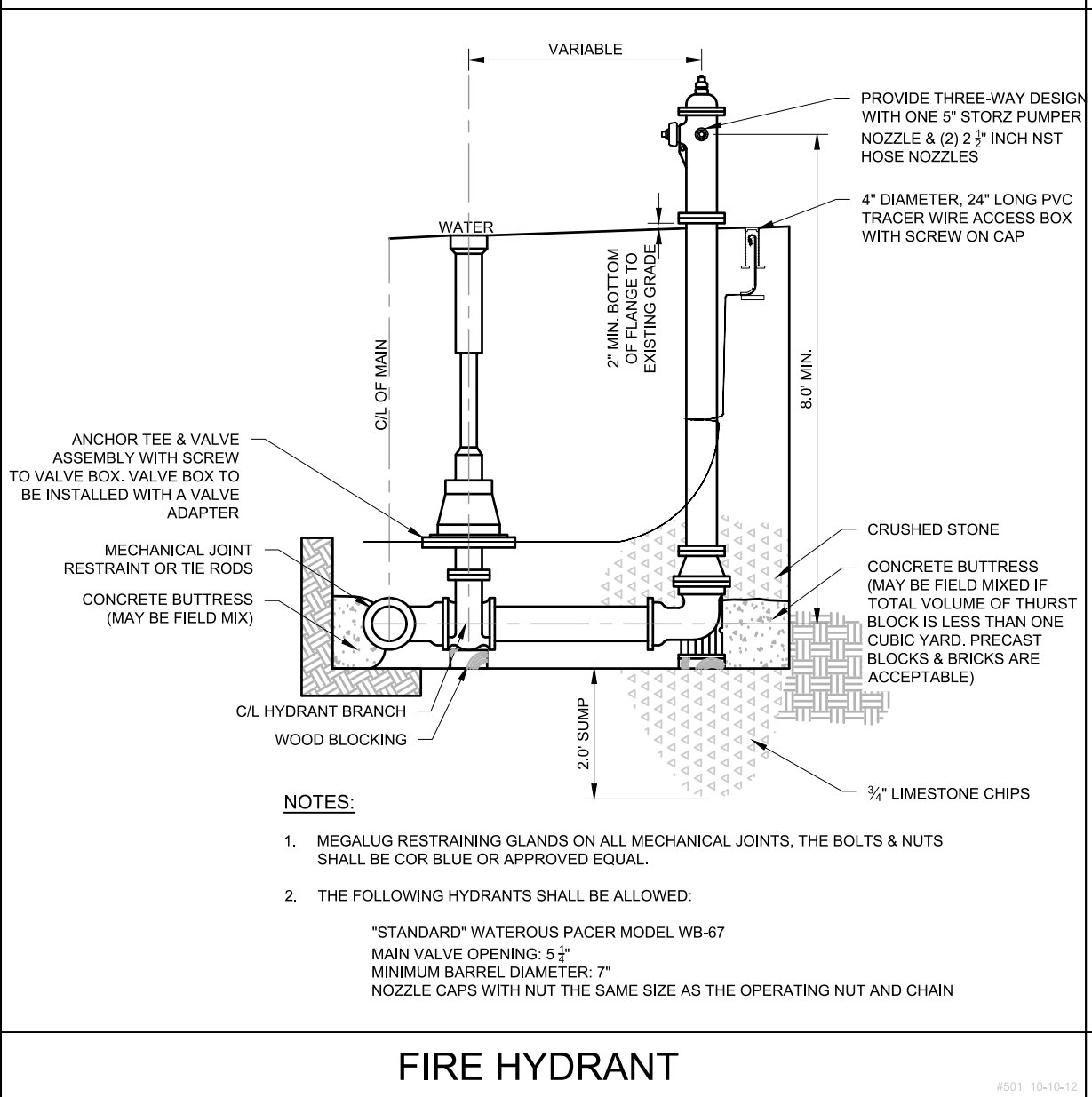

FIRE HYDRANT

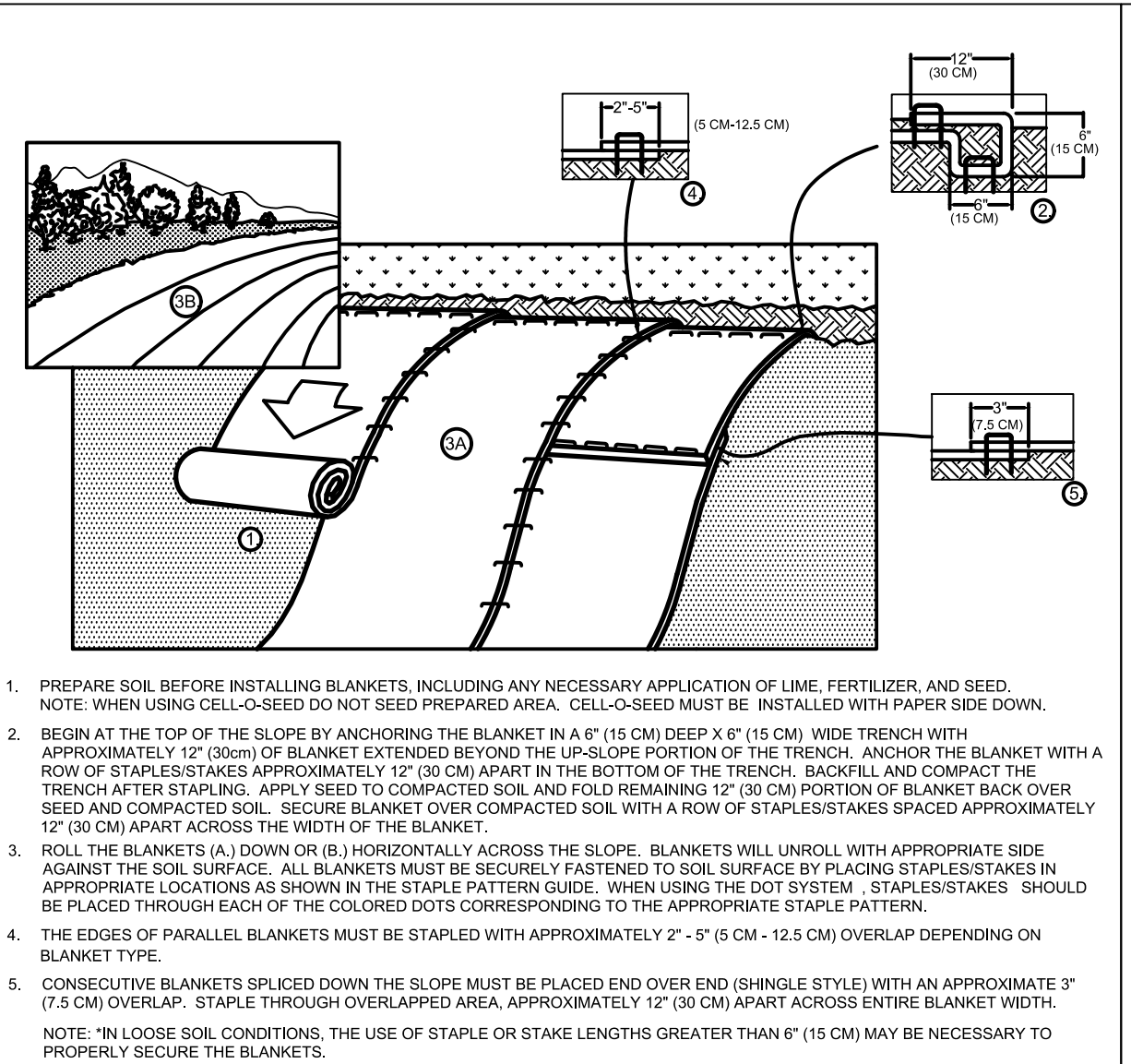

EROSION MATTING - SLOPE INSTALLATION

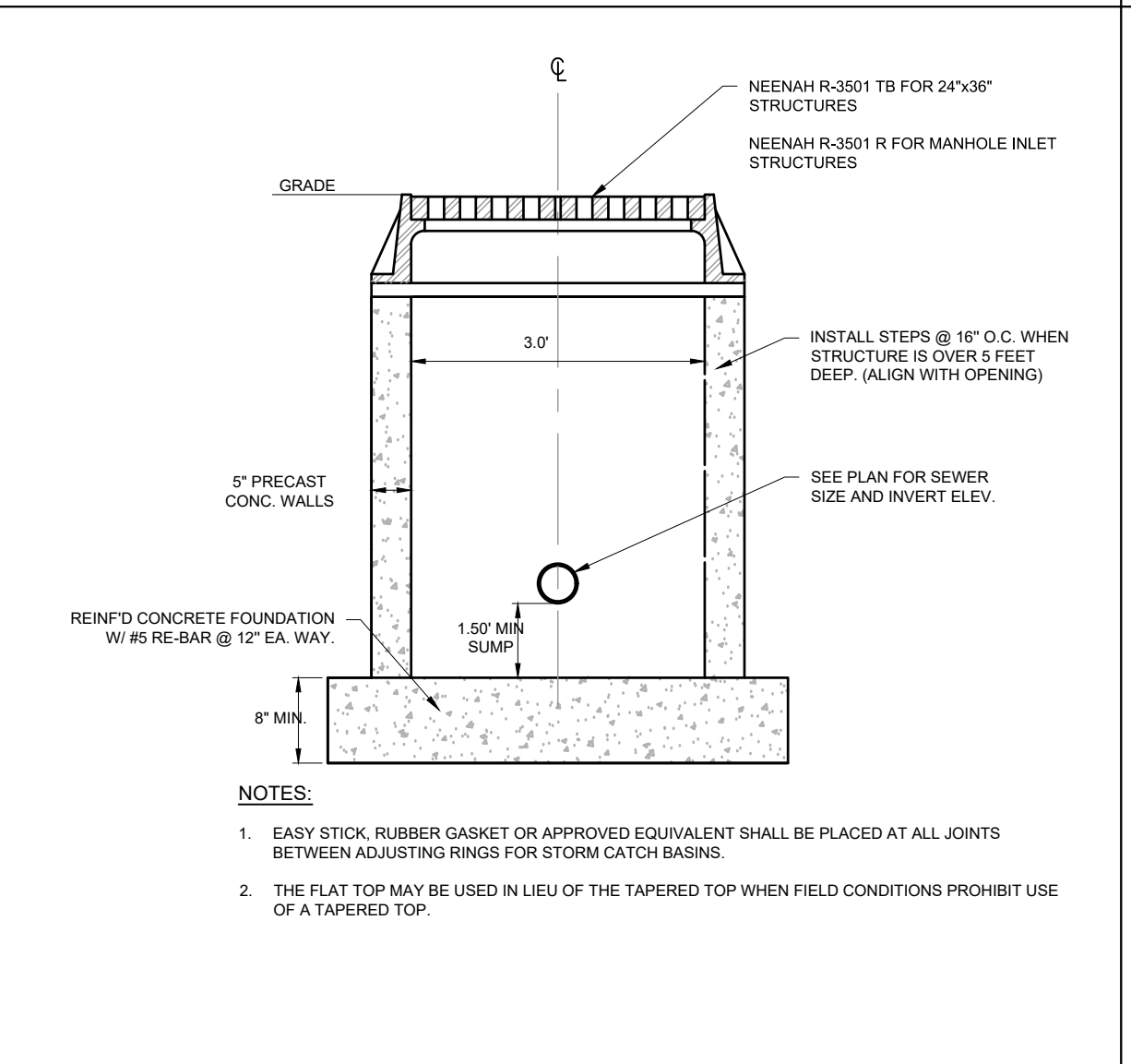

2' x 3' CATCH BASIN

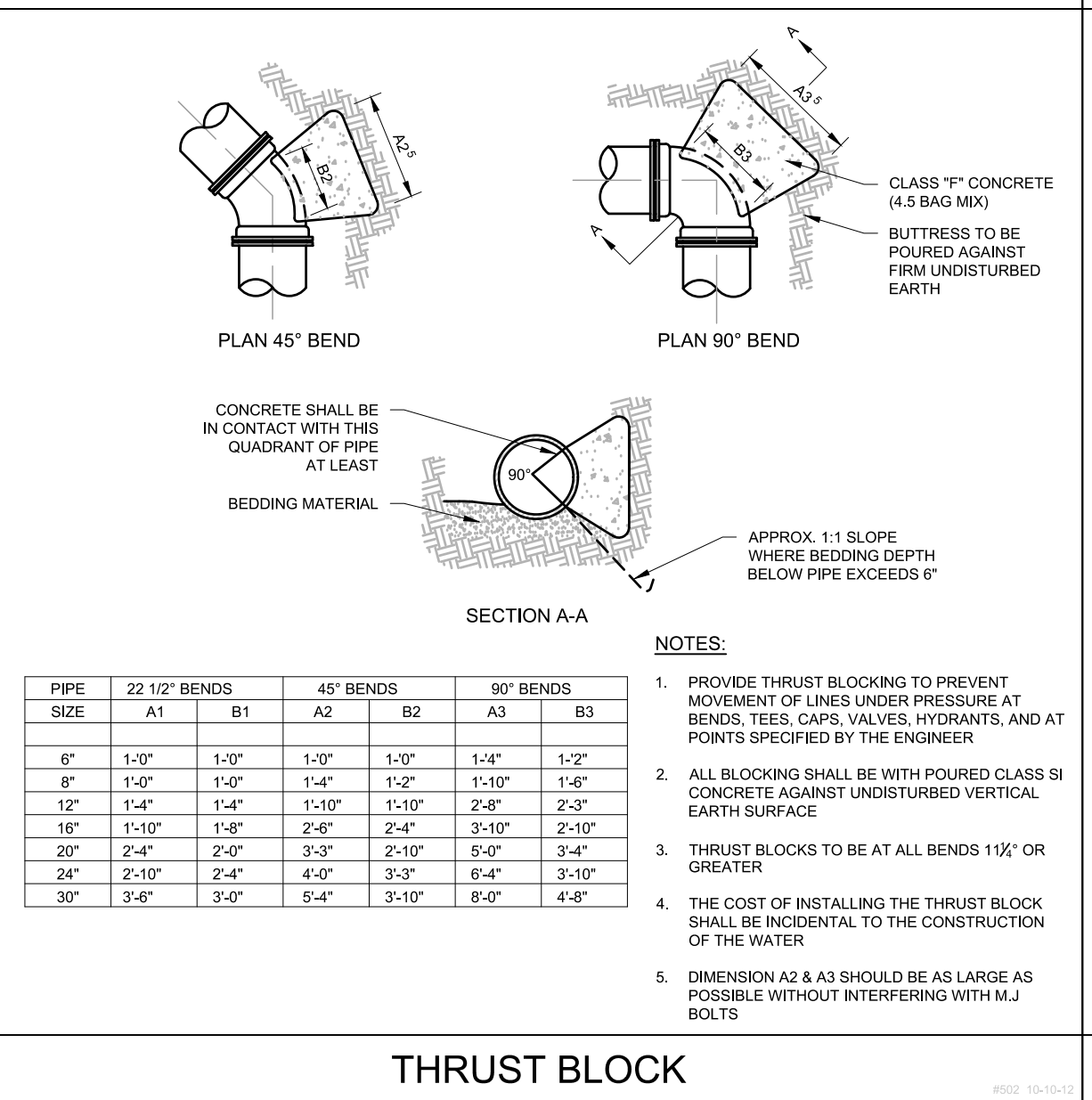

THRUST BLOCK

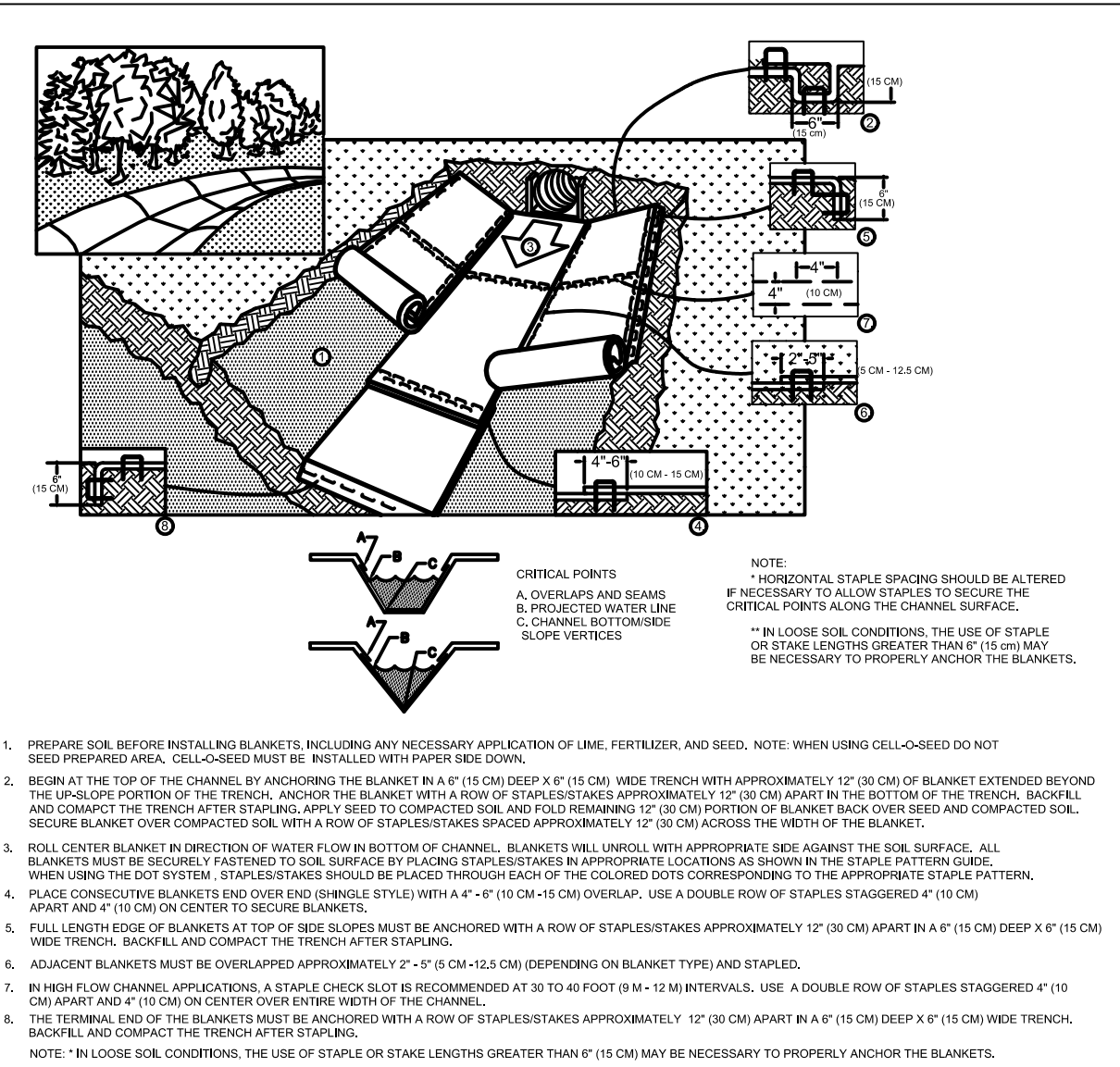

EROSION MATTING - CHANNEL INSTALLATION

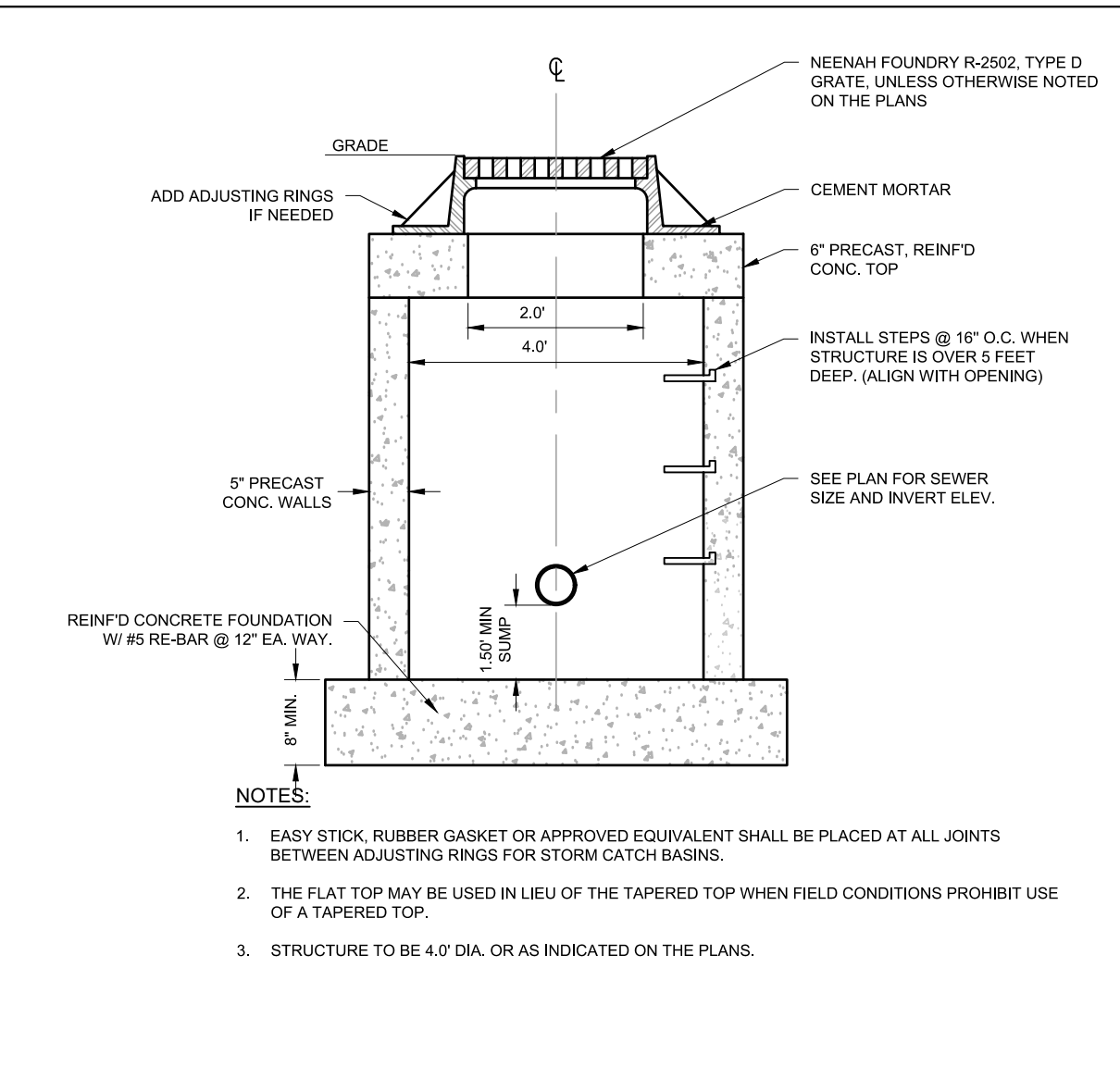

CATCH BASIN

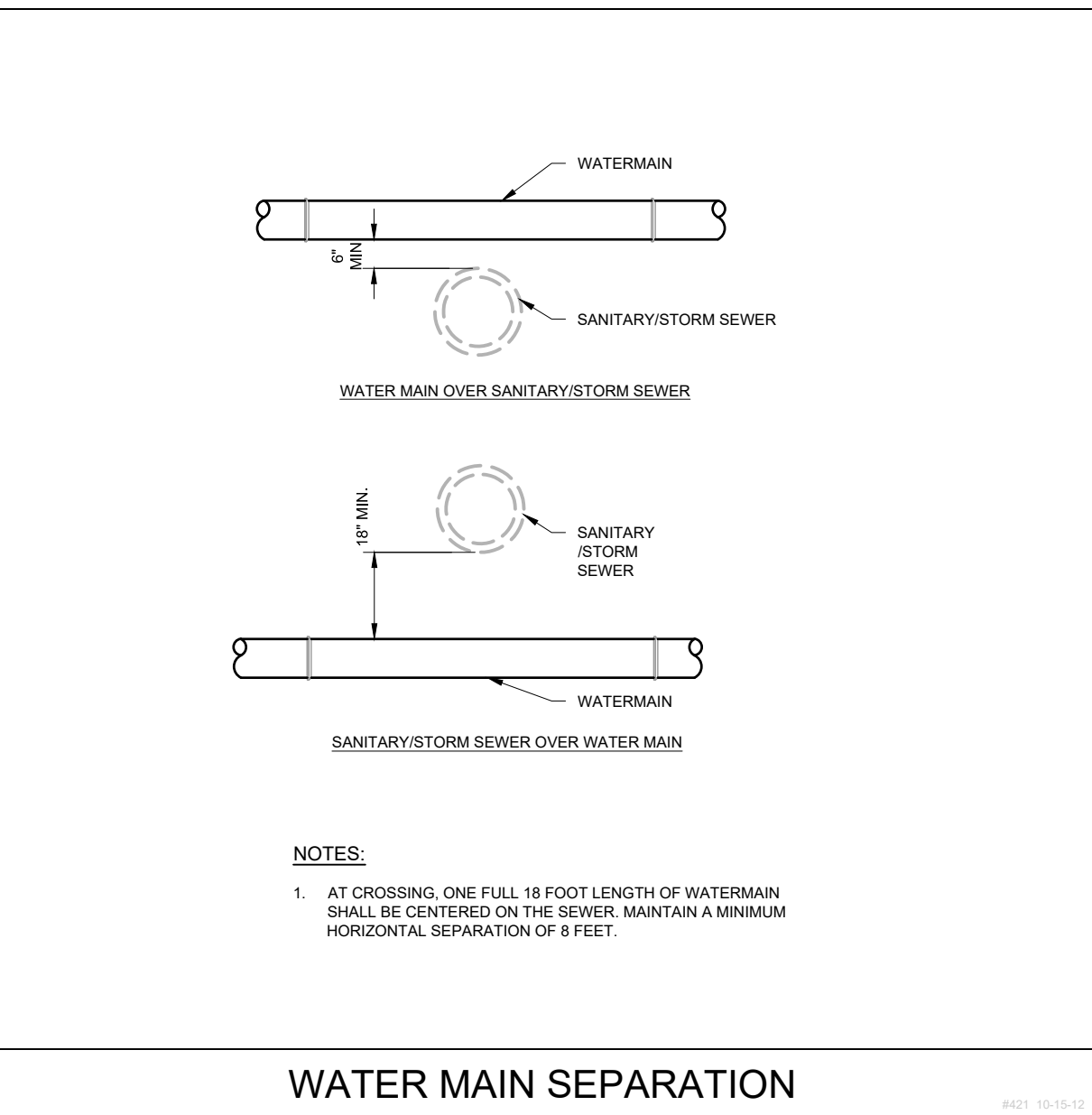

WATER MAIN SEPARATION

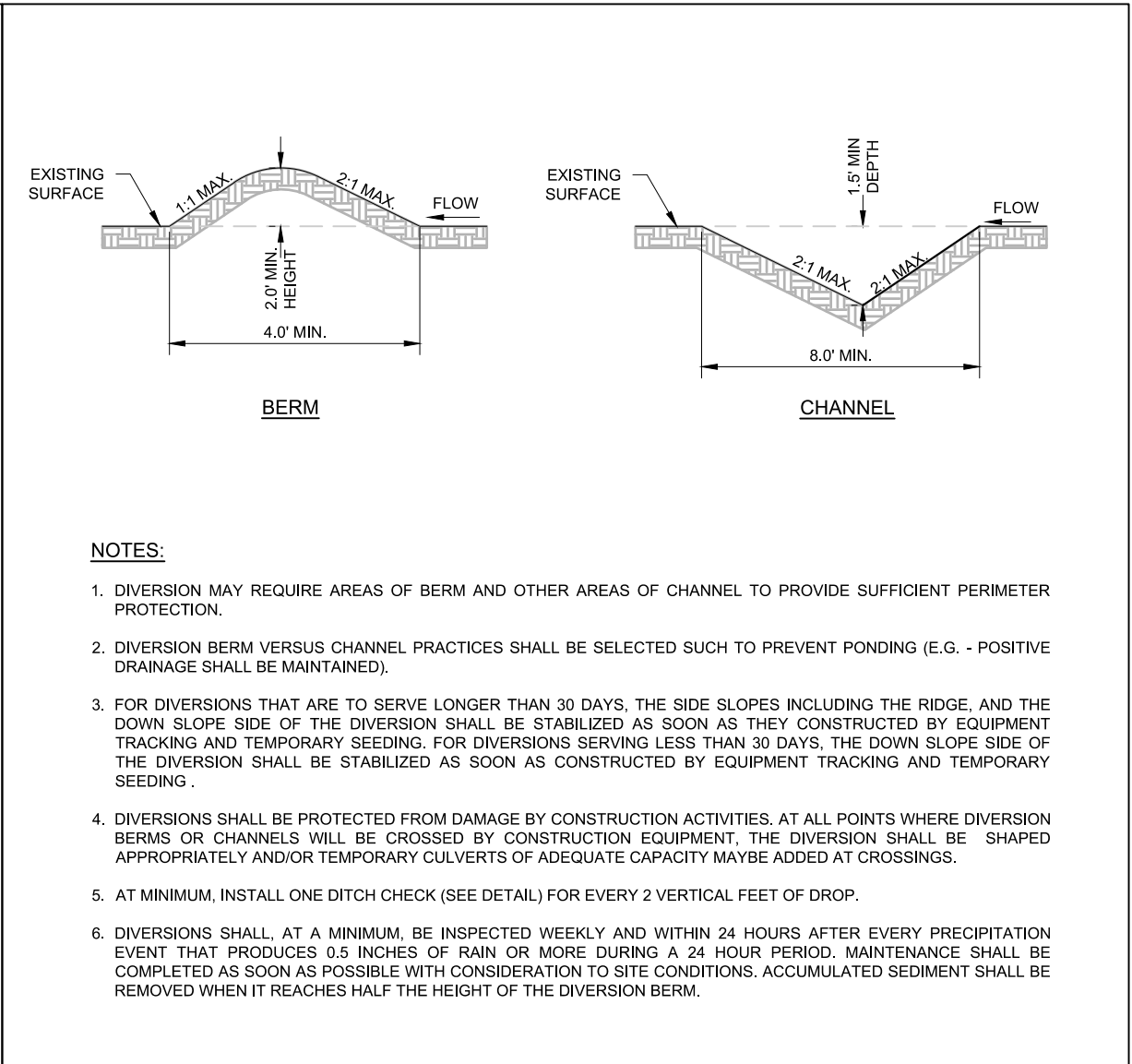

DIVERSION BERM / CHANNEL

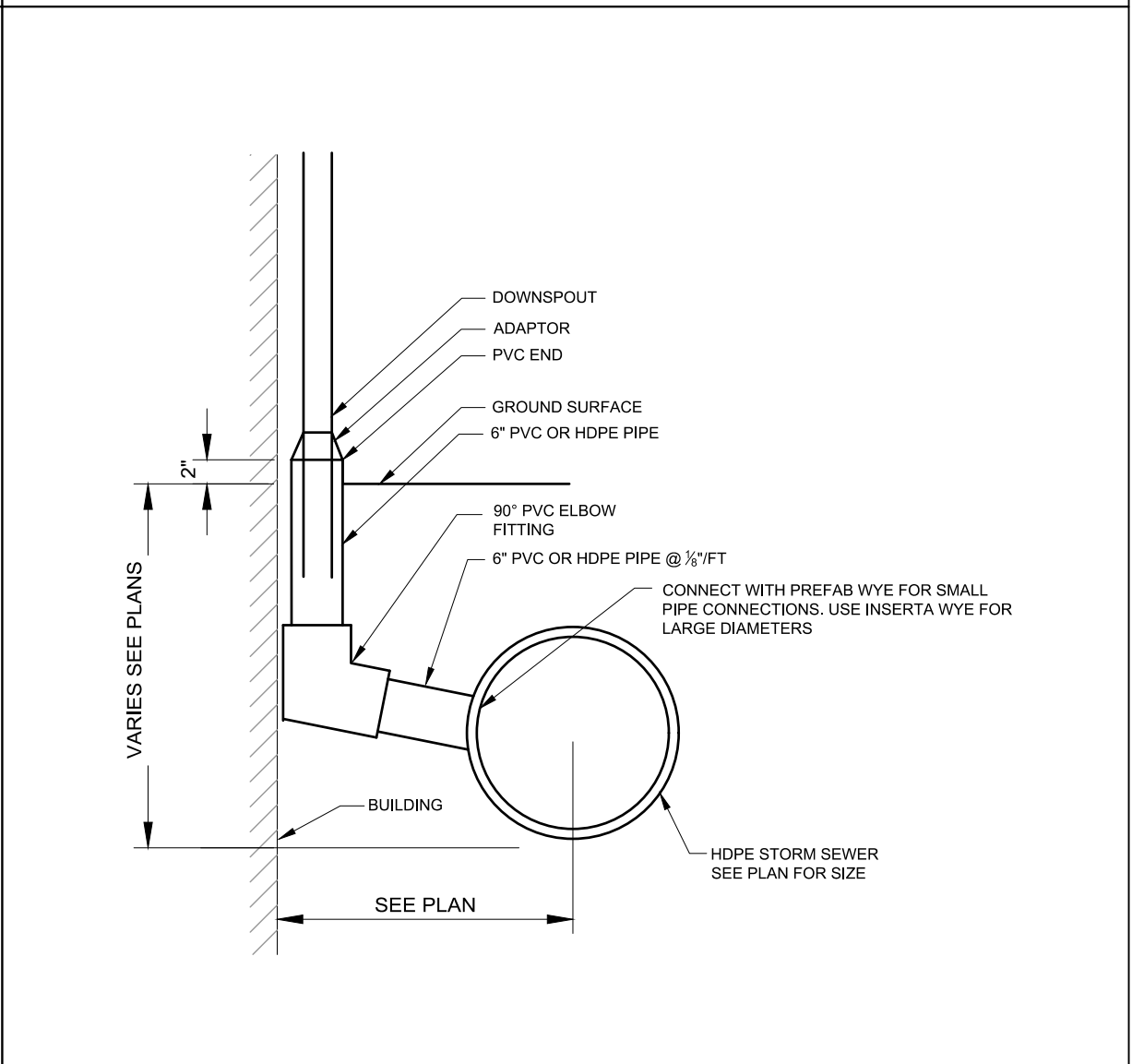

DOWNSPOUT DRAIN BUILDING CONNECTION

